



CABINETCORP™

CabinetCorp was founded on the shoulders of industry professionals with more than 60 years of combined cabinetry experience supplying finished wood products to the construction and home building industry. Our business materialized from a passion to achieve an unmet need to simplify the process of remodeling outdated, unattractive and non-functional kitchens.

With our nationwide reach, we bring exceptional value and quality ready-to-assemble cabinetry directly to contractors, designers, and builders all over the globe. The ease of our online ordering system, our abundant inventory, and industry leading lead times makes us the only superb choice for RTA cabinetry.

Quality:

We offer ready-to-assemble and pre-assembled cabinetry in various door styles and color choices, simple closet solutions, as well as accessories. Designed to the highest standards in style and function with efficiency in mind, our durable construction and quality finish ensure longevity. Unlike other cabinet suppliers, we provide a limited lifetime warranty on all our cabinets and products, as well as a satisfaction guarantee.

Service:

Our commitment to customer service ensures your satisfaction throughout every phase of your project. CabinetCorp's goal is to provide valuable industry related information to make it easier for contractors to get the quality cabinets that their clients are wanting in the quickest way possible. Our customer service team and design staff are readily available to answer your calls, emails, or chats. We welcome your comments, questions, or concerns.

Sample Doors

Framed Collection - Traditional Prime

Shaker



White



Antique White



Dusk



Gray



Charcoal Gray

Tacoma



White

Cambridge



Antique White



Sable

Sample Doors
are available
to purchase
individually or
as a kit.

Frameless Collection - Contempo Prime

Tempo



White Prairie



Grey Wilderness



Dark Wilderness

Palena

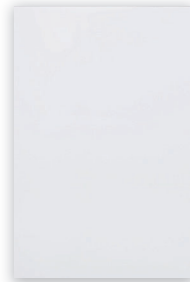

Gloss White

Arlen - COMING 2022



Vienna
Pristine Blanco

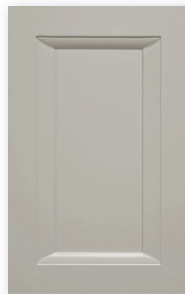

Vienna
Simple Grey

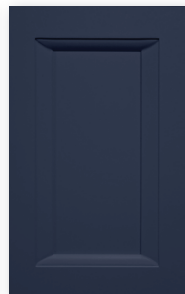

Vienna
Majestic Navy

Marketing Tools



Tri-Fold Brochure

Marketing Materials are available to purchase individually or as a kit.



40 Page Catalog



Specification Manual

Dealer Policies

- As an authorized CabinetCorp dealer, it is **YOUR** responsibility to communicate our policies, product information, order information, claim information, etC. to your customer.
 - **CabinetCorp will not provide any details to your customer at any time nor will we be held responsible for any inaccurate information provided by you or your associates.**
- All online resale of CabinetCorp products must be approved PRIOR to offering it for sale.
 - If online resale is approved by CabinetCorp, you are only allowed to resale on the website specified at the time of approval. Approval for resale on additional websites will need additional approval from CabinetCorp.
- Prior to publicizing your selling price, all dealers must adhere to the minimum advertised price as confirmed with your CabinetCorp representative.
- CabinetCorp will not accept shipping damage claims for warehouse pick up orders that are later shipped at dealer's discretion.

Order Processing & Payment

4

- All orders from CabinetCorp approved dealers will be accepted online only.
- **Full Payment is required before an order will be processed.** (This includes backorders and approved written add-ons).
- It is the responsibility of the consumer to check all measurements and SKUs prior to ordering to confirm you are ordering the accurate pieces. CabinetCorp will not be responsible for ordering errors.
- Payment can be made by Credit Card, Debit Card, or PayPal.
- Once an order is in process, no changes can be made. Additional items can be processed online as a new order.
- **Shipped Order Lead Time:**
 - LTL Freight shipping is available for all flat pack orders and will ship within 3-5 full business days.
 - Assembled orders are processed and shipped within 15 full business days.
- **Warehouse Pickup Order Lead Time:**
 - Flat pack warehouse pickup orders are processed and made available for pickup within 3 full business days.
 - Assembled warehouse pickup orders are processed and made available for pickup within 15 full business days.
- **RUSH ORDERS** will be processed for an additional fee for **flat pack orders ONLY.** (All orders with rush services are subject to total item quantity review.) The "Rush Fee" only applies to warehouse processing time and does not apply to transit time to your destination.

- Same day warehouse pickup is available for flat pack orders placed by 12:00 PM (local warehouse time) and require a minimum 3 hour processing time.
- Same day shipping is available for flat pack orders placed by 12:00 PM (local fulfilling warehouse time). Orders placed after 12:00 PM will be processed the following business day.
- Rush Advantage is unavailable for assembly orders and discontinued lines. Combined orders subject to refund of rush fee.
- Rush Advantage must be selected at the time of checkout.
- "Day One" starts on the **NEXT** full business day after the order is placed.
- Cancellations after the order is picked will be subject to a 15% processing fee.
- Cancellations made after an order is shipped are subject to a 25% restocking/processing fee.

Assembly & Modifications

- Assembly and limited modifications are available for warehouse pickup and freight shipped orders (from select warehouse) for additional labor and shipping fees as calculated by the website.
- A limited number of modifications are available **ON FRAMED ASSEMBLED ITEMS ONLY**, including:
 - Increased Depth
 - Decreased Depth
 - Prep for Glass: Route Door(s) & Finish Interior
 - Double Oven Conversion
- Modifications exempt the entire order from normal lead times and can take up to an additional 5 business days for completion.
- **Full payment must be received** prior to start of modifications.

5

Shipping & Delivery

- All LTL freight orders are packaged in individual boxes, placed on a pallet, shrink wrapped and strapped.
- All LTL freight shipping charges are calculated online at the time of checkout.
- CabinetCorp reserves the right to fulfill orders between multiple shipments from different distribution facilities, without prior notification to the customer and with no additional cost applied.
 - If a customer requests changes to their selected shipping method after the time of checkout additional charges may apply

LTL Shipping

- There is a 2-5 business day standard transit time with LTL carriers. **Please account for at least one extra day for residential deliveries and deliveries requiring a scheduled delivery appointment.**
- **Shipping charges must be paid for when your order is placed online.** (Orders exceeding standard LTL sizes are subject to additional fees for Full Truckload shipping).
- You will receive a tracking number by email the day after the order has shipped.
- All destinations must be **tractor/trailer accessible**, or Limited Access fees will be applied.
- For residential deliveries and deliveries requiring appointments, the **freight company will contact you** 24 hours in advance to schedule the delivery (usually a 3-4 hour window).
- Shipping charges cover ONE delivery attempt. The customer is responsible for any additional shipping and handling charges for delivery failure due to customer circumstances.

LTL Delivery Policies

- The driver is only responsible for placing the pallet on the ground for deliveries that had lift gate services selected at the time of check out.
- Address classifications are based on city zoning; therefore, it is possible to have a commercial property in a residential area. In this case the delivery would be considered residential, and subject to the residential delivery fees and conditions.
- A responsible party must be present to inspect, inventory, and sign off on delivery.
- Regional delivery services are available in select markets. Rates and delivery services vary by market.
 - You **MUST** notate if the number of pallets delivered does not match the number listed on the driver's delivery receipt copy.
 - Careful inspection of packaging conditions is vital to file freight claims. Any visible damages must be noted on the paperwork when signing for the delivery, as well as documented with photos. Even if you are not sure if the contents inside contain damages due to the exterior's condition, you **MUST** indicate on the delivery receipt to be able to claim concealed damages in the future.
 - Do **NOT** reject damaged items. The delivery should be accepted, with documentation of the damage, and a claim should be filed online. SEE IMPORTANT NOTES IN MISSING AND DAMAGED ITEMS SECTION TO FOLLOW.

Warehouse Pick Up Orders

- Orders **MUST** be picked up within **10 business days** of receiving the ready for pick up email notification.
- After ten business days has passed, storage fees will begin to accumulate as follows:
 - \$25/day per open order
 - Fees will accumulate up to two weeks maxing out at \$250
 - Five weeks after the ready for pickup notification has been sent, the order will returned to inventory and refunded less the max \$250 and a 10% restocking fee.

- If storage fees are applied to your order(s), the order(s) will be released for pickup after any fees assessed are paid for in full.
- Orders placed for warehouse pick up are not palletized, wrapped, or strapped for shipping purposes.
 - If you are sending a delivery service that requires secure palletizing of products the order will incur additional packaging & labor fees and must be approved by CabinetCorp prior to pick up.
- For liability purposes, CabinetCorp will not help load warehouse pick up orders without approval from the pickup party
- CabinetCorp will not accept transit damage claims on warehouse pick up orders that are picked up and/or shipped with delivery services contracted out at the dealer's discretion.

Replacements for Missing or Damaged Items (Including Concealed Damage)

- CabinetCorp has final determination of resolution for any manufacturer warranty claims submitted. Solutions should be discussed with CabinetCorp prior to being promised to the end customer.
- Blemishes or other damages not impacting the structural integrity of a cabinet will not warrant a full cabinet replacement. CabinetCorp reserves the right to provide alternative products or components as solutions.
- Freight claims for obvious damage or shortage can only be accepted **when indicated on the bill of lading.**
- Freight damage claims must be filed within 5 business days. No claims will be allowed without the proper paperwork noting the damage at the time of delivery.
- To file a claim for a damage or a shortage, please log into our website and use our damage claim module.
- The following must be included to process the claim:
 - Order number
 - Buyer's name
 - Shipping address for replacements
 - Brief description of damage or shortage, including item numbers and/or parts
 - Picture or video of the damage are required
 - Picture or video of the damaged packaging and product are required to be eligible for full replacement
- Upon receipt of the damage claim, we will review the request within 48 business hours. Replacements will then be shipped out within 24-48 hours.
- Expedited shipping service is **NOT** available for replacements and/or parts.
- All damages must be documented and reported upon opening the boxes.
 - Missing items must be reported within **one week** from delivery.
 - Concealed damages must be reported within **15 days** from delivery.
- Items that have been assembled and installed **cannot** be claimed as damaged.
- **CabinetCorp cannot be held responsible for any labor costs accrued during the installation of any of its products sold via any of its channels of distribution. This includes, but is not limited to, items that may be flawed or have become damaged in transit.**

Return Merchandise Authorizations (RMA)

- All returns must be authorized by CabinetCorp prior to return shipment.
- For authorization, please send an email request to support@cabinetcorp.com
- Returns must be received by CabinetCorp within 14 days of purchase.
- All items must be returned in original, unopened packaging, therefore **NO RETURNS ON ASSEMBLED CABINETS.**
- No returns on trims, mouldings, fillers, panels or 3rd party vendor items.
- No returns on discontinued cabinet styles.
- QUALIFYING returns will incur a 25% RESTOCKING FEE.
- The customer is responsible for setting up and covering all return shipments.
- Any returned product DEEMED UNSELLABLE **WILL NOT RECEIVE CREDIT.**

Marketing Policies

- CabinetCorp cannot be held liable for applicable marketing costs for marketing our products.
- Private labeling is done at dealer's discretion.
- The use of any images and sales materials in your private label marketing can be released by emailing team@cabinetcorp.com.

Third Party Design Programs

- CabinetCorp does not guarantee the accuracy of any third party design software. This includes (but is not limited to) 2020 Design and ProKitchen Design softwares.
- Please refer to your dealer portal for accurate information on CabinetCorp product specifications and pricing.

Construction

Are your cabinets constructed with solid wood?

Framed Collection

- *Doors & Drawer Fronts* -
 - All stained doors, drawer fronts, and frames are constructed from 3/4" solid Birch hardwood. Our Cambridge Sable style has a solid birch center panel, while our stained Shaker Charcoal Gray has a veneered MDF center panel.
 - Our painted styles feature an all HDF door: Shaker White, Shaker Gray, Shaker Dusk, Shaker Antique White, Tacoma White, and Cambridge Antique White.
- *Cabinet Box* - Our framed cabinet boxes are constructed from solid Birch hardwoods and furniture grade plywood. All materials are CARB2 compliant for standard US restrictions for formaldehyde emissions.
- *Drawer Box* - Our framed cabinetry features four-sided drawer boxes constructed from 5/8" thick solid hardwood, dovetail joints, and a fully captured 3/8" thick plywood floor.

Frameless Collection

- *Doors & Drawer Fronts* -
 - Our Tempo style feature a fully edge banded, thermofused textured melamine over engineered wood, with a matching back.
 - Our Palena style features a fully edge banded, high-gloss PET laminate over engineered wood, with a matte melamine back.
 - Our Vienna style features a five-piece HDF painted door.
- *Cabinet Box* - Our frameless cabinet boxes are constructed using MDF and furniture grade plywood. All materials are CARB2 compliant for standard US restrictions for formaldehyde emissions.
- *Drawer Box* - Our frameless cabinetry comes standard with our altamax drawer box. The altamax drawer box is a four-piece construction box complete with 1/2" thick metal sides and 5/8" thick thermofused melamine engineered wood back and floor.

How is the interior of the cabinet finished?

Framed Collection

- Our framed cabinetry comes standard with UV coated natural interiors. Glassdoor "GD" cabinets have interiors that are painted or stained to match the exterior.

Frameless Collection

- Our cabinet boxes feature a grey linen thermofused melamine in and out.

Are your cabinets CARB2 certified?

Yes, all CabinetCorp products are 100% in compliance with CARB Phase 1 & CARB Phase 2 defined guidelines of composite wood products.

Are your cabinets strong enough to support a granite countertop?

Our plywood core construction for all of our cabinets ensures the strength required to support granite, concrete, or any other countertop material that you may select. No additional cabinet reinforcement is required.

Do your cabinets have soft-close doors and drawers?

Soft-close doors and drawers are standard on all of our current cabinet collections (excludes select discontinued styles).

Is a finished panel required for exposed cabinet ends?

Framed Collection

- No, all of our framed cabinets come with finished exteriors.

Frameless Collection

- Yes, features a standard grey linen thermofused melamine exterior, so panels will be needed to finish the exposed ends.

How much weight can the cabinet drawers hold?

Framed Collection

- Our framed cabinet drawer boxes have a weight capacity of 70 lbs.

Frameless Collection

- Our drawer boxes have the following weight capacities:
 - K-height (5") 88 lbs
 - C-height (6-¾") 132 lbs.

Do you sell paint color or stains that match the finishes of the cabinetry you offer?

We do not carry the paint color or stains to sell direct but we have partnered with Sherwin Williams for easy access to purchase our finishes. Simply visit a Sherwin Williams in your area, let them know you are interested in a custom paint color or stain from their National Accounts database under the name 'BGI'. Once the store associate has accessed the account successfully, provide them with the paint color/stain you are looking for: **Cambridge Antique White:** BGI-CW, **Cambridge Sable:** BGI-CS, **Tacoma White:** BGI-TW, **Shaker White:** BGI-SW, **Shaker Antique White:** BGI-SA, **Shaker Dusk:** BGI-SD, **Shaker Gray:** BGI-SG, **Shaker Charcoal Gray:** BGI-SC, **Vienna Pristine Blanco:** BGI-VPB, **Vienna Simple Grey:** BGI-VSG, **Vienna Majestic Navy:** BGI-VMB

Retail locations can accomplish matching any paint color for your projects however, paint color/stains are only recommended for smaller items such as trims & mouldings. For an accurate match for larger items, you will need to contact a Sherwin Williams Professional Coatings Group.

Ordering

What forms of payment do you accept?

We accept all major credit cards (Visa, American Express, MasterCard, and Discover), debit card & PayPal.

How can I check the status of my order?

You can view the progress of your orders by logging into your account and selecting "Orders" under the "My Account" dashboard dropdown menu. The order status will be displayed next to your order as well as an email notification being sent to the account holder.

Do you offer credit terms?

We currently do not offer any sort of credit terms to our customers. All orders must be paid in full prior to processing and shipping any orders.

What is your return policy?

We do accept returns in certain circumstances. Please see the 'Return Merchandise Authorizations (RMA)' section of our Terms & Conditions for details.

Delivery

How do you ship your cabinetry?

Most orders will be shipped on a pallet via an LTL (Less than Truckload) carrier. Some smaller items may ship through a small parcel carrier.

How long will it take to receive my cabinets?

Flatpack Orders

- Flatpack orders are processed and shipped out of our facilities within 3 to 5 full business days. Transit time to your location can vary from 1-6 business days depending on your location and the services required at delivery. (Backorders are exempt from normal lead times.)

Assembled Orders

- Standard assembled orders are processed and shipped within 10 to 15 full business days. Transit time to your location can vary from 1-6 business days depending on your location and the services required at delivery. (Backorders and modification orders are exempt from normal lead times.)

What if my delivery includes damaged cabinets?

If your order is received damaged, please notate any damages with the freight company on the delivery receipt when accepting the delivery and take photos of the damaged items. Most importantly, do not refuse the shipment. Submit a claim online with the photos of the damages or send them immediately to team@cabinetcorp.com. CabinetCorp will review and replace damaged pieces in a timely manner.

Limited Lifetime Warranty

Brothers Global Inc warrants to the original consumer purchaser that CabinetCorp cabinetry, door hinges, and drawer glides will be free from defects in material and workmanship under normal use and service for the lifetime of the product (Proof of Purchase is required). This warranty is not transferable and only applicable to product used for residential purposes. Representatives of CabinetCorp do not have the authority to change or enlarge this warranty.

This warranty does not cover normal wear and tear, damage or defects caused by accidents, misuse, abuse, or lack of necessary maintenance; nor does it cover alteration, modification, improper installation, improper handling / storage, environmental conditions, nor any labor expenses.

Brothers Global Inc., at our option, may elect to repair or replace with a functionally equivalent product any CabinetCorp product covered by this warranty. Some replacement parts are subject to availability and may differ from original parts received. Return of defective product may be required for a replacement to be issued. Repair parts or replacement parts are at the expense of Brothers Global Inc., but customer shall bear all other expenses. These expenses may include, but are not limited to, cost of removal and re-installation of product, labor expenses, etc.

Just as no two trees are alike, no two pieces of wood are alike. The variation in color and grain pattern in wood adds to its natural beauty and is not considered an imperfection. Environmental factors, including but not limited to artificial / natural light, moisture, cleaners, smoke, etc, may cause the darkening or mellowing of a cabinet over time. This is a natural process and can be expected. This warranty does not cover the natural aging or darkening / mellowing of wood color, the inherent growth characteristics of, or variation in wood.

Some of the cabinet lines feature a glazed finish which accentuates the door and drawer front profiles. This glaze is hand applied over a stain or paint and may, due to the nature of application, consist of random drips, runs, etc. As glazing is a hand applied process, there will be variations in color and appearance from door to door and cabinet to cabinet. This is not considered a defect and is considered normal with hand applied finishes. It is the nature of wood to expand and contract to varying degrees depending on climate conditions. As a result, cabinet lines with painted surfaces may show fractures in the paint at joints. This is normal and is not considered a defect.

This warranty is valid only in the United States of America and Canada and is not transferable. All implied warranties are limited in duration to the shorter of the period provided by law or the period of this warranty. To the extent permitted by law, this warranty excludes special, incidental, or consequential damages. Some states do not allow the exclusion or limitations of incidental or consequential damages or limitations on how long an implied warranty lasts, so the above limitations or exclusions may not apply to you. This warranty gives you specific legal rights; you may have other rights which vary from state to state. To exercise this warranty, please contact the CabinetCorp supplier from whom you purchased the product. Report, in writing, to team@cabinetcorp.com all defects claimed and include proof of purchase documentation.

TEMPO

(*Specifications subject to change without notice)



**WHITE PRAIRE
(TWP)**

- Horizontal Textured Melamine White Woodgrain Engineered Wood Door and Drawer Faces
- White Grey Linen Thermofused Melamine Carcass with Matching Interior
- Full Depth 18mm Adjustable Shelf with Full Edge Banding
- 18mm Plywood Composite Box
- Hettich Sensys Adjustable 110° Soft-Close Hinges
- Adjustable Black Leg Supported Included
- Altamax Full Extension Soft-Close Orion Grey Drawer Box



**GREY WILDERNESS
(TGW)**

- Horizontal Textured Melamine Grey Woodgrain Engineered Wood Door and Drawer Faces
- White Grey Linen Thermofused Melamine Carcass with Matching Interior
- Full Depth 18mm Adjustable Shelf with Full Edge Banding
- 18mm Plywood Composite Box
- Hettich Sensys Adjustable 110° Soft-Close Hinges
- Adjustable Black Leg Supported Included
- Altamax Full Extension Soft-Close Orion Grey Drawer Box

TEMPO

(*Specifications subject to change without notice)



DARK WILDERNESS (TDW)

- Horizontal Textured Melamine Dark Brown Woodgrain Engineered Wood Door and Drawer Faces
- White Grey Linen Thermofused Melamine Carcass with Matching Interior
- Full Depth 18mm Adjustable Shelf with Full Edge Banding
- 18mm Plywood Composite Box
- Hettich Sensys Adjustable 110° Soft-Close Hinges
- Adjustable Black Leg Supported Included
- Altamax Full Extension Soft-Close Orion Grey Drawer Box

PALENA

(*Specifications subject to change without notice)

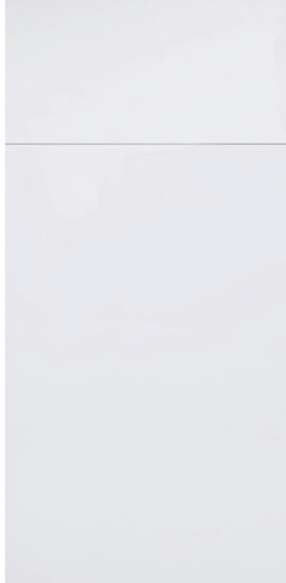

GLOSS WHITE (PGW)

- High Gloss White PET Laminate Engineered Wood Door & Drawer with Seamless Edge Technology & White Melamine Back
- White Grey Linen Thermofused Melamine Carcass with Matching Interior
- Full Depth 18mm Adjustable Shelf with Full Edge Banding
- 18mm Plywood Composite Box
- Hettich Sensys Adjustable 110° Soft-Close Hinges
- Adjustable Black Leg Support Included
- Altamax Full Extension Soft-Close Orion Grey Drawer Box

ARLEN - COMING 2022

(*Specifications subject to change without notice)



**VIENNA
PRISTINE BLANCO
(VPB)**



**VIENNA
SIMPLE GREY
(VSG)**



**VIENNA
MAJESTIC NAVY
(VMN)**

- Frameless Full Access Construction
- Five Piece Painted HDF Door
- Universal 18mm Plywood Composite Cabinet Box with a Grey Linen Thermofused Melamine Inside & Out
- Full Extension Soft-Close Orion Grey Drawer Box
 - Blum Legra Upgrade Available
- Full Depth 18mm Adjustable Shelf with Full Edge Banding
- Hettich Sensys Adjustable 110° Soft-Close Hinges
- Leg System

CONSTRUCTION SPECIFICATIONS

(*Specifications subject to change without notice)

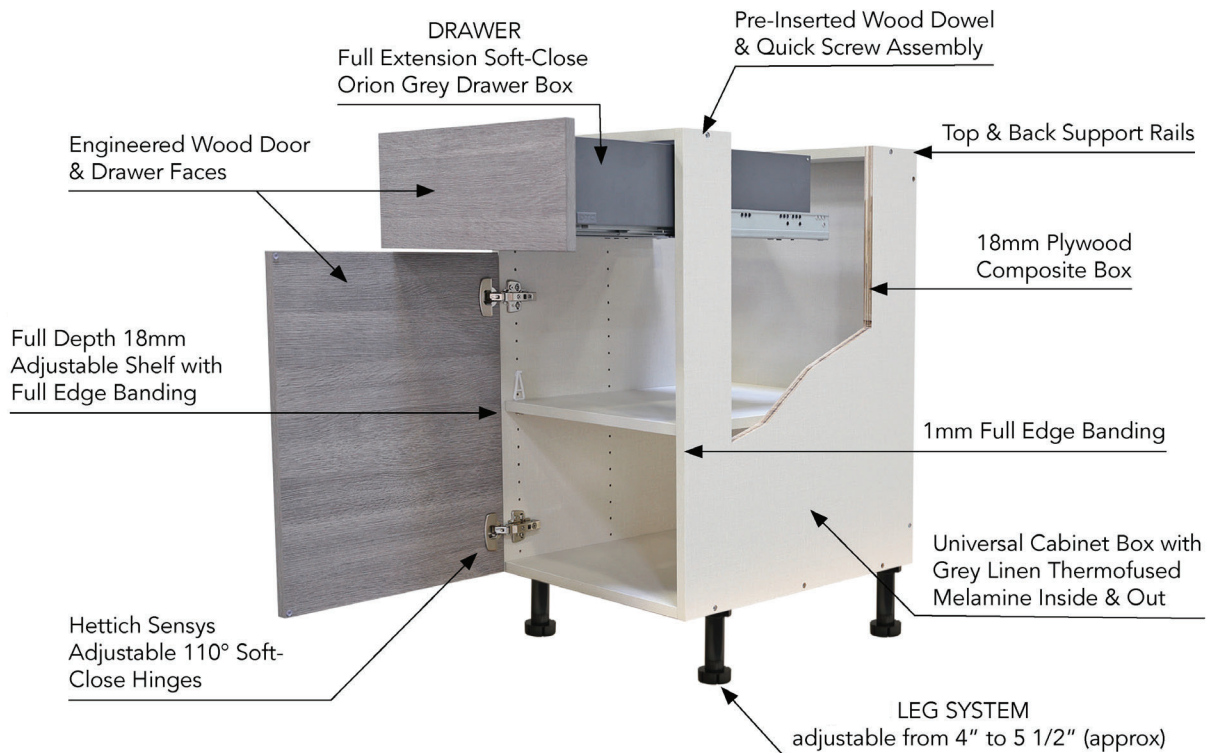

17

FIG 1.1: FINISHED SIDE PANELS

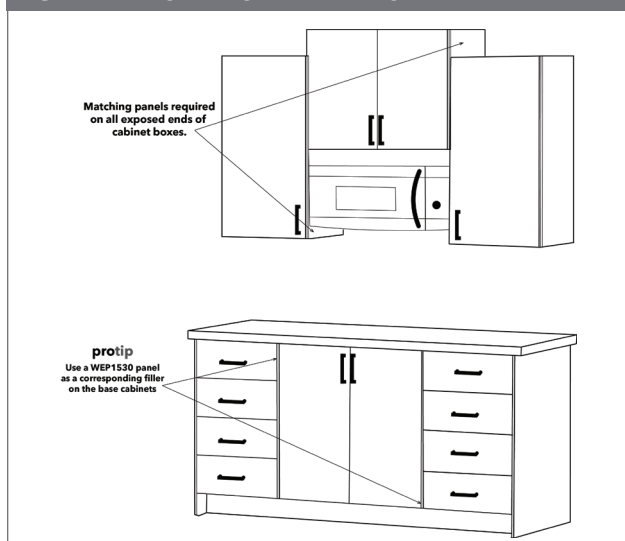

Our frameless cabinet boxes feature a universal grey linen box color in and out. When designing a 3/4" panel is required anytime there is an exposed end. Remember to also use a panel next to appliances or when varying cabinet heights are used.

Protip - To align the wall and base cabinets, use a WEP1530 (cut in half) as a filler on the base cabinets to correspond with the panels on the wall cabinets. See FIG 1.1

Frameless side panels are oversized and designed to be trimmed down in order to come flush with the door front, giving an inset appearance.

When using in an island or peninsula application, the finished panel should be flush with the back panel and door/drawer front. See FIG 1.2

FIG 1.2: FINISHED SIDE PANELS



FIG 2: FILLERS

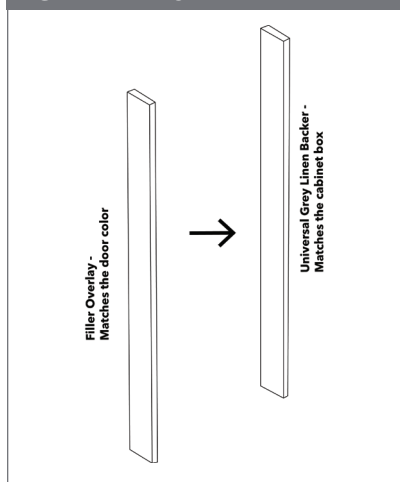

Our fillers include a backer and separate front overlay piece. The backer is the same grey linen color as the cabinet box, and the overlay filler matches the door material. See FIG 2

Frameless base end panels can either be installed with a recessed 4-1/2"H toe kick, or they can be used at full height and placed directly onto the floor. See FIG 3

FIG 3: END PANEL INSTALLATION TYPES

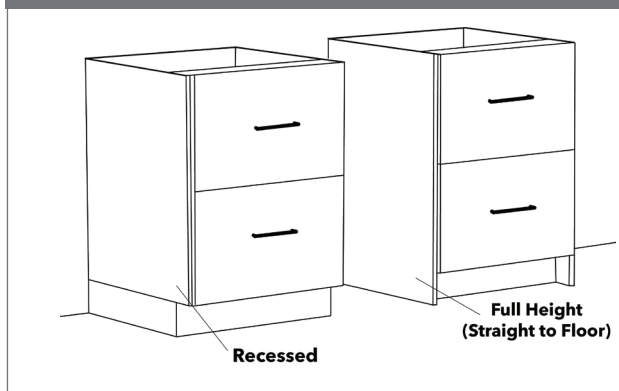

*To maintain the contemporary style, we offer Wall Easy Reach cabinets and a full range of Blind Corner cabinets as a clean-lined alternative to a diagonal corner.

FIG 4: TOE KICK BOX

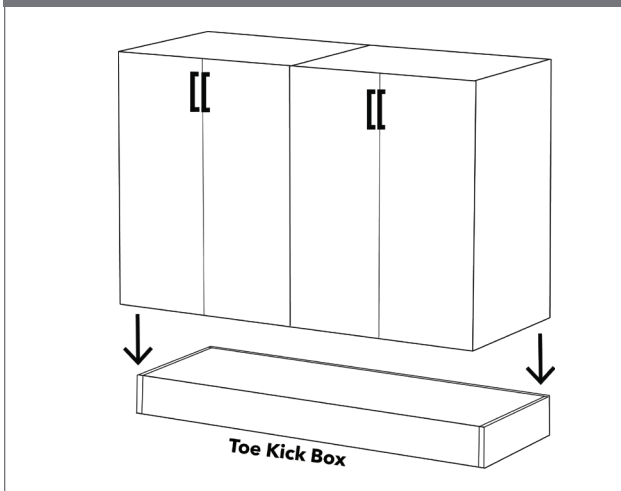

When designing islands and peninsulas, it is not recommended to use the adjustable legs at the base of the cabinetry, as this can cause slipping. To ensure stability, a **toe kick box** can be secured to the floor, then the cabinets can be attached to the toe kick box frame. See FIG 4

Our Tall Cabinets feature a 72"H standardized box. To reach the desired overall height of either 84, 89 or 94"* , a wall cabinet can be stacked on top of the tall cabinet can be stacked on top of the tall utility box.

Our 24" deep wall cabinets are available in heights of 12, 18 or 23". See FIG 5

FIG 5: UTILITY CABINETS

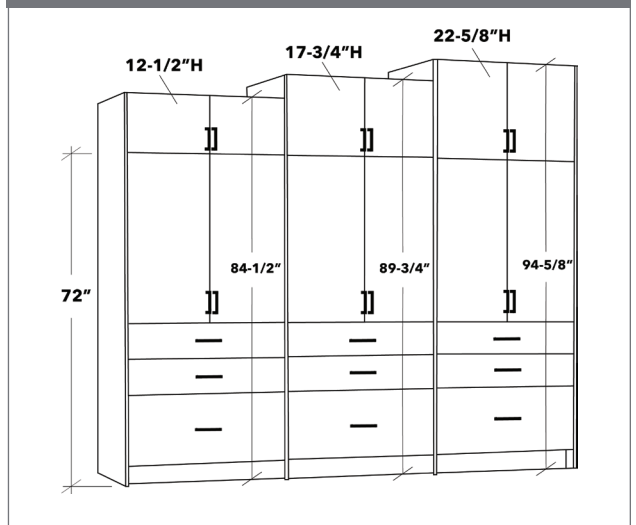
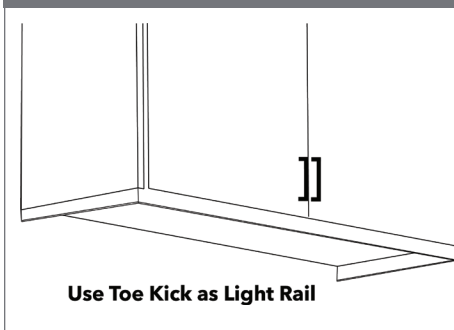

FIG 6: LIGHT RAIL



To construct a light rail, utilize toe kick molding with the light strip tucked behind.

The toe kick can be cut down to the desired length and height. See FIG 6

Our base cabinets are designed without an integrated toe kick. The cabinets come with adjustable legs, and the toe kick can be attached onto the front of the legs. See FIG 7

FIG 7: ADJUSTABLE LEGS

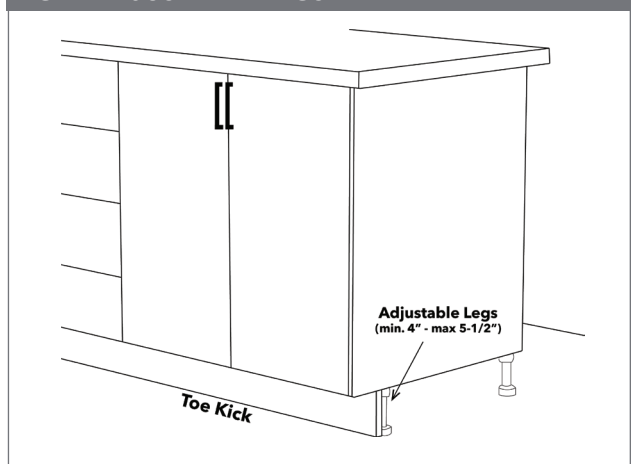

*Refer to specifications for exact heights and depths on cabinets, fillers and panels.

PRODUCT SPECIFICATIONS

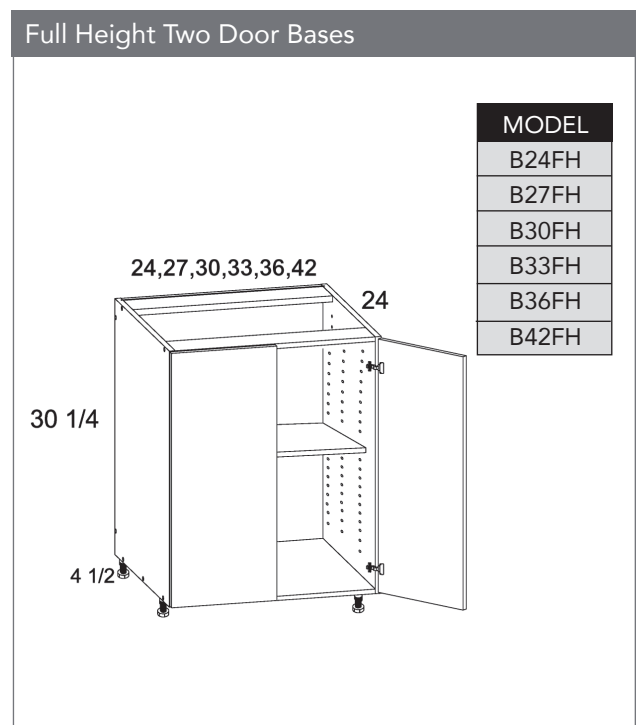
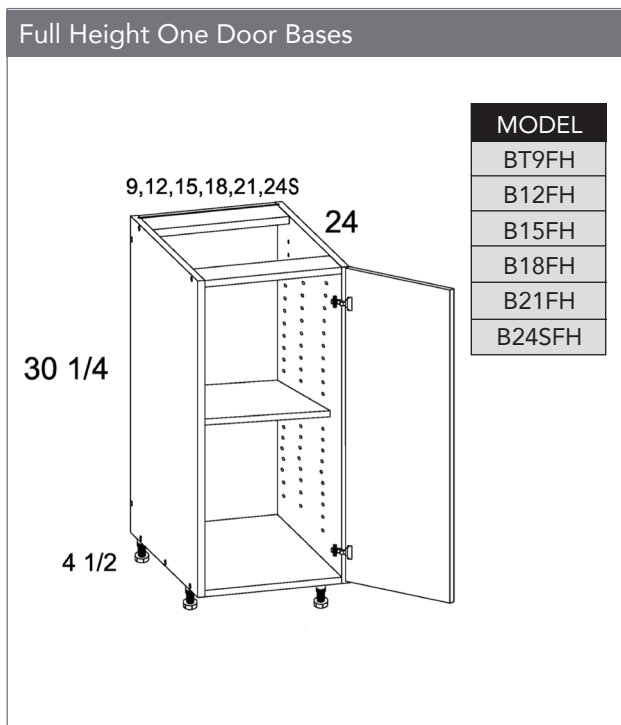
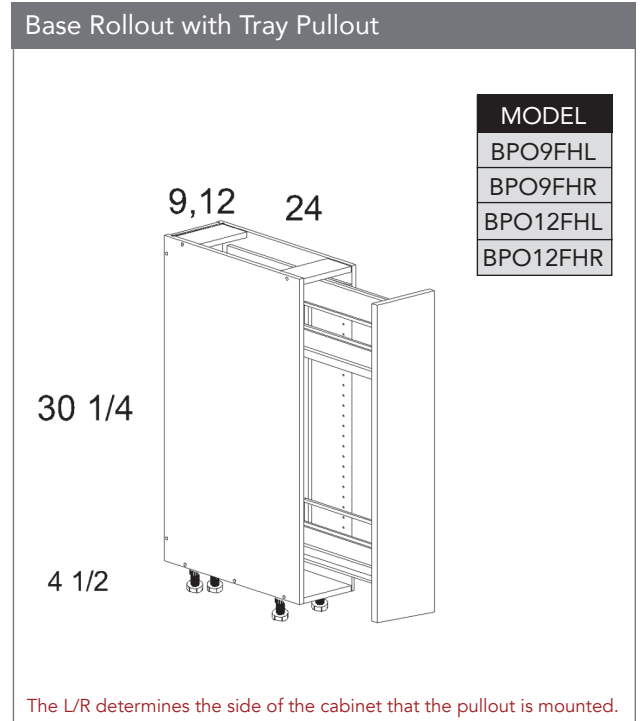
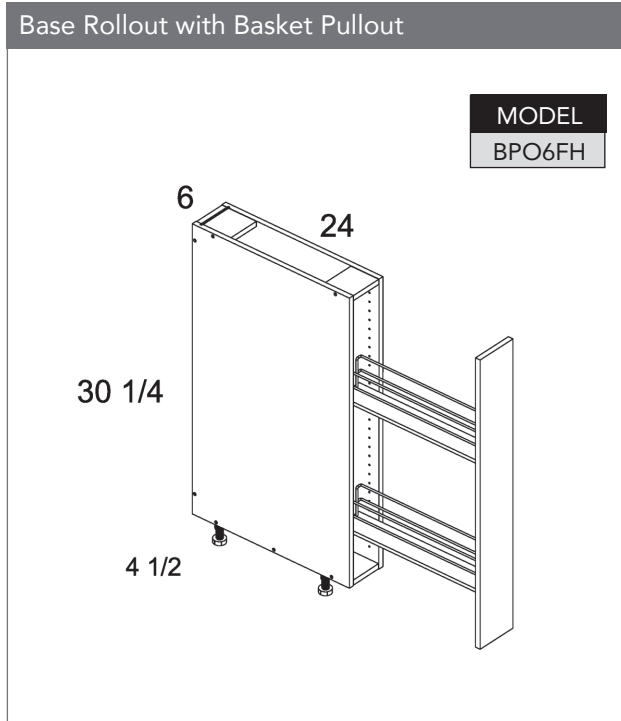

PRODUCT SPECIFICATIONS

One Door One Drawer Bases

MODEL
B12
B15
B18
B21
B24S

Two Door One Drawer Bases

MODEL
B24
B27
B30
B33
B36

Two Drawer Bases

MODEL
2DB12
2DB15
2DB18
2DB21
2DB24
2DB27
2DB30
2DB33
2DB36
2DB42

Two Drawer Bases with One Inner Drawer

MODEL
2DBID12
2DBID15
2DBID18
2DBID21
2DBID24
2DBID27
2DBID30
2DBID33
2DBID36

PRODUCT SPECIFICATIONS

Two Drawer Bases with Two Inner Drawers

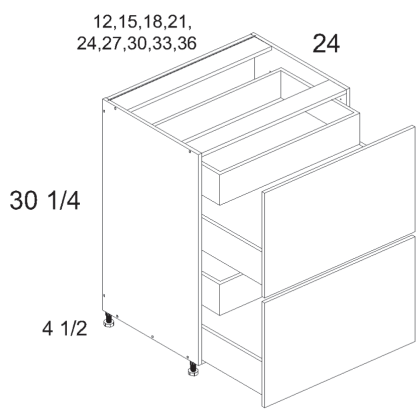

MODEL
2DB2ID12
2DB2ID15
2DB2ID18
2DB2ID21
2DB2ID24
2DB2ID27
2DB2ID30
2DB2ID33
2DB2ID36

Three Drawer Bases

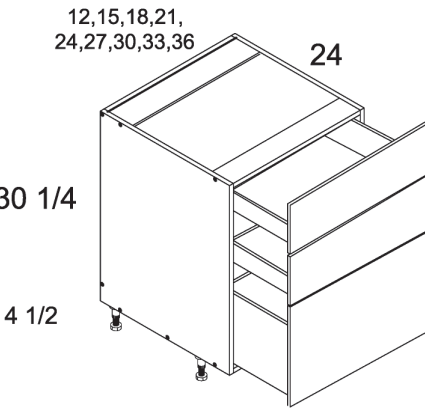

MODEL
3DB12
3DB15
3DB18
3DB21
3DB24
3DB27
3DB30
3DB33
3DB36

22

Four Drawer Bases

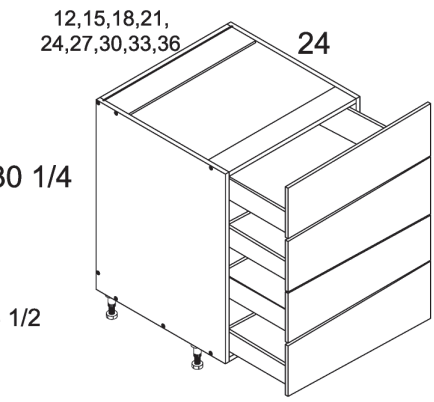

MODEL
4DB12
4DB15
4DB18
4DB21
4DB24
4DB27
4DB30
4DB33
4DB36

Full Height One Door Sink Bases

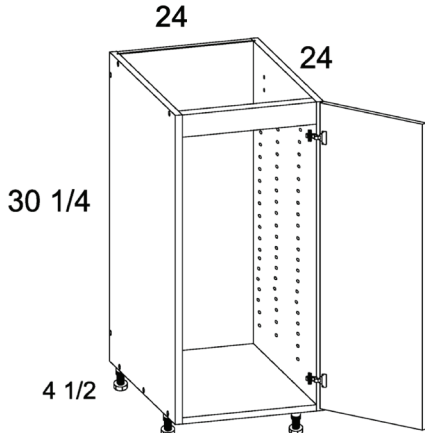

MODEL
SB24SFH

PRODUCT SPECIFICATIONS

Full Height Two Door Sink Bases

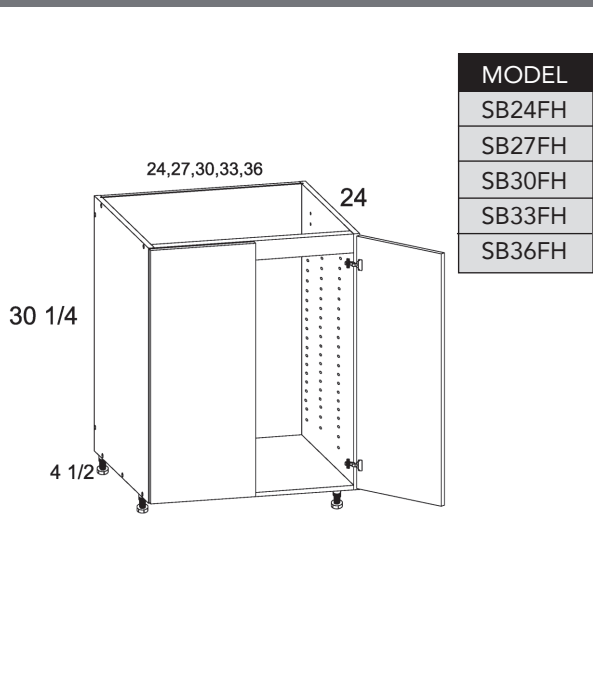

One Door with False Front Sink Bases

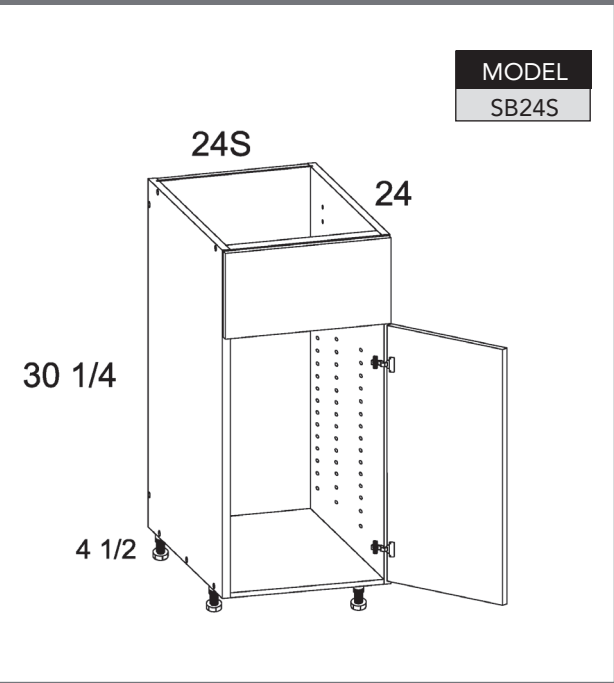

Two Door with False Front Sink Bases

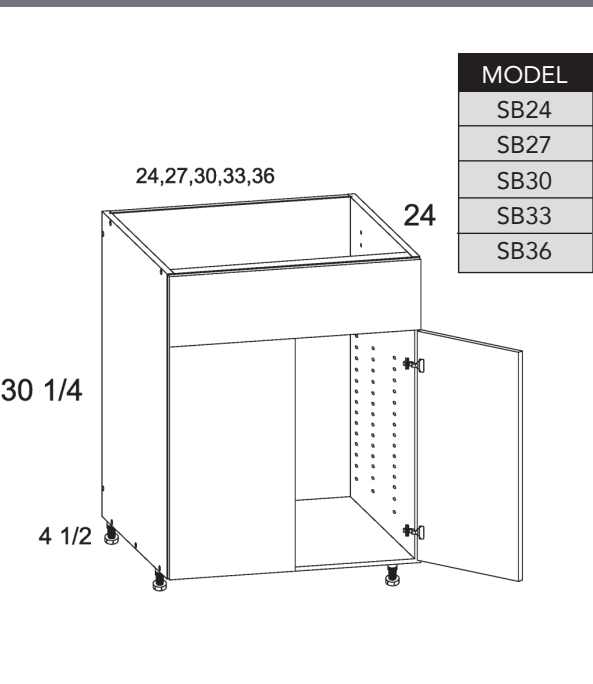

Farm Sink Bases

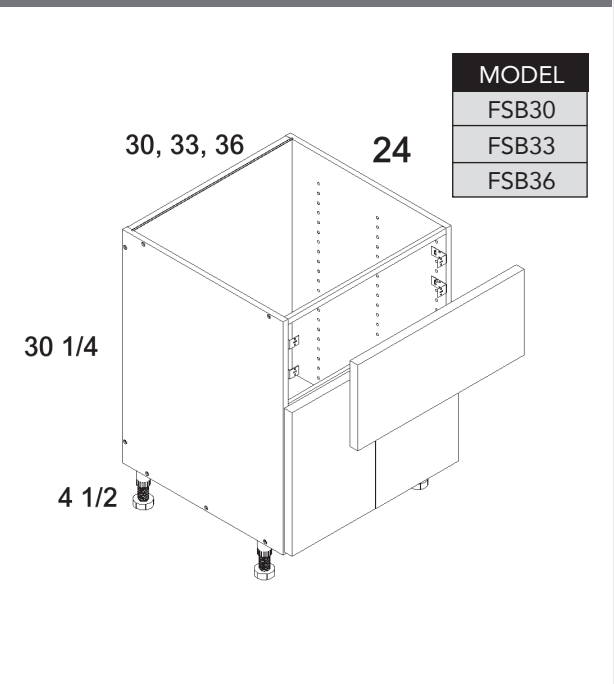

PRODUCT SPECIFICATIONS

Two Drawer Range Bases

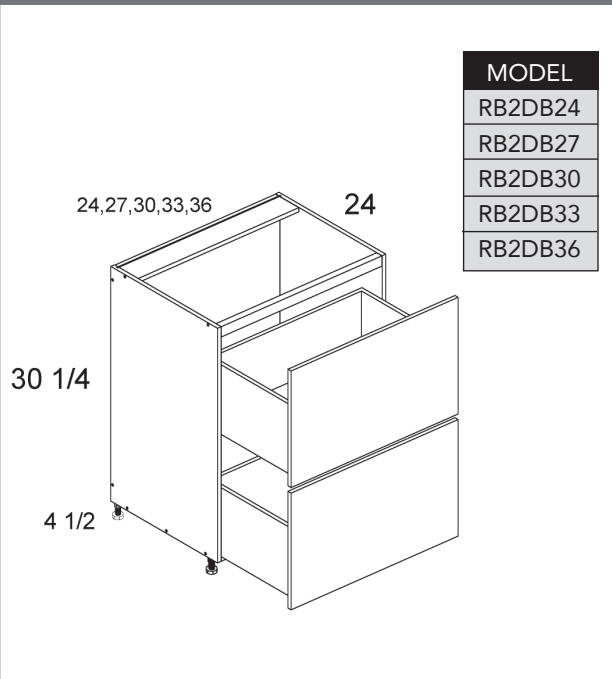

Two Drawer with False Front Range Bases

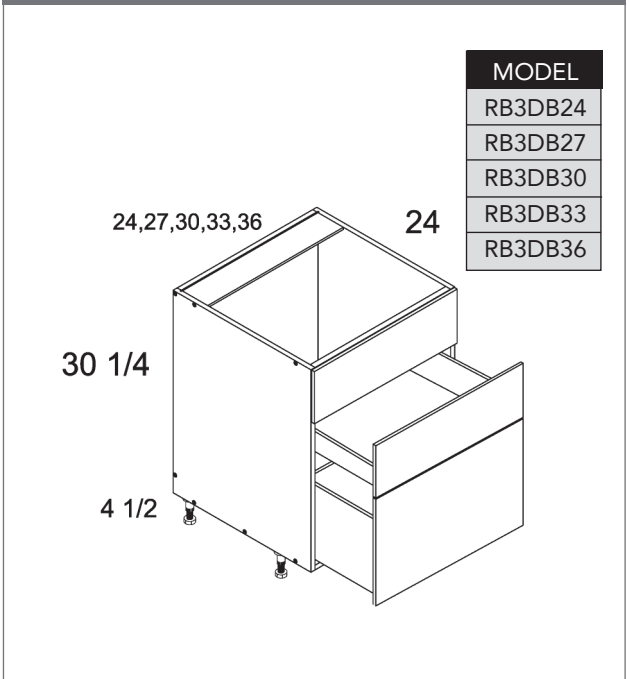

24

Three Drawer with False Front Range Bases

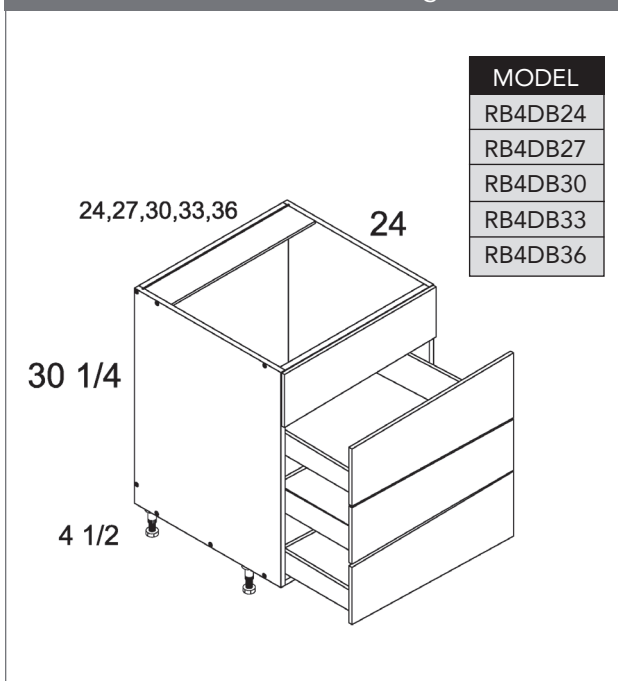

Full Height One Door Blind Bases

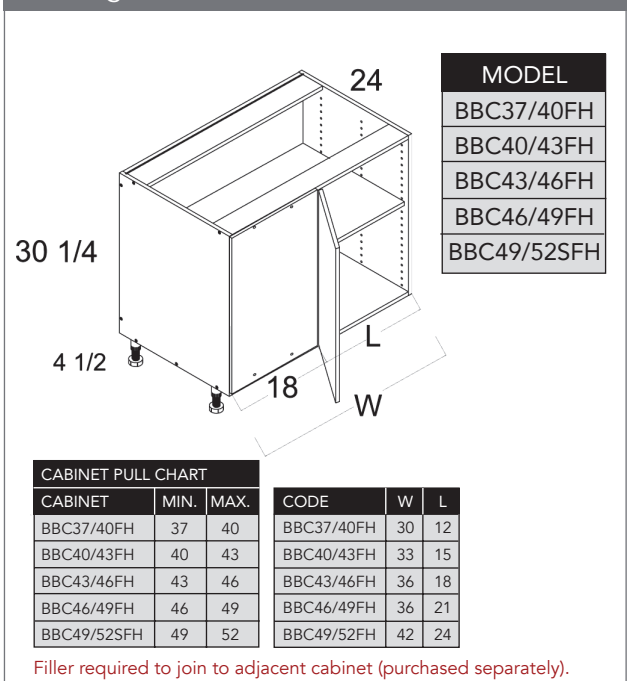

CABINET PULL CHART

CABINET	MIN.	MAX.	CODE	W	L
BBC37/40FH	37	40	BBC37/40FH	30	12
BBC40/43FH	40	43	BBC40/43FH	33	15
BBC43/46FH	43	46	BBC43/46FH	36	18
BBC46/49FH	46	49	BBC46/49FH	36	21
BBC49/52SFH	49	52	BBC49/52FH	42	24

Filler required to join to adjacent cabinet (purchased separately).

PRODUCT SPECIFICATIONS

Full Height Two Door Blind Bases

MODEL

BBC49/52FH

BBC52/55FH

CABINET PULL CHART

CABINET	MIN.	MAX.	CODE	W	L
BBC49/52FH	49	52	BBC49/52	42	24
BBC52/55FH	52	55	BBC52/55	45	27

Filler required to join to adjacent cabinet (purchased separately).

Base Easy Reach

MODEL

BER33

BER36

Base Easy Reach with Lazy Susan Tray

MODEL

LSB33

LSB36

Microwave Bases

MODEL

BMW27

BMW30

PRODUCT SPECIFICATIONS

Full Height One Door Desk Bases

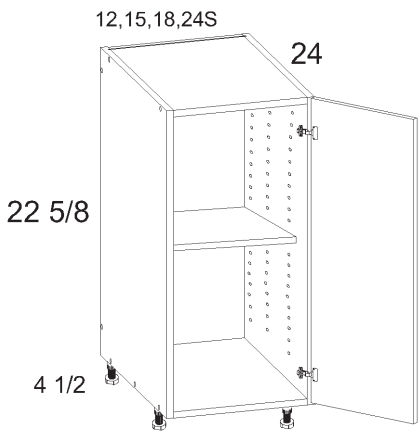

MODEL
DDO12
DDO15
DDO18
DDO24S

Full Height Two Door Desk Bases

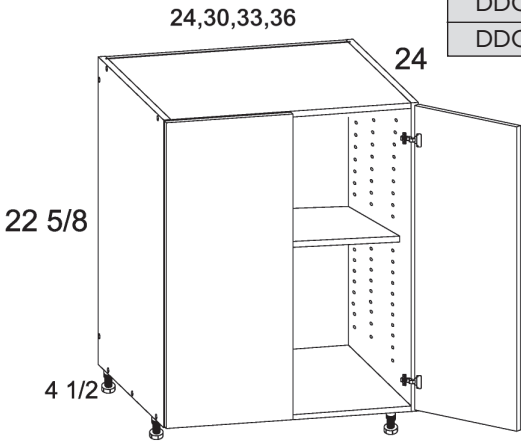

MODEL
DDO24
DDO30
DDO33
DDO36

26

Two Drawer Desk Bases

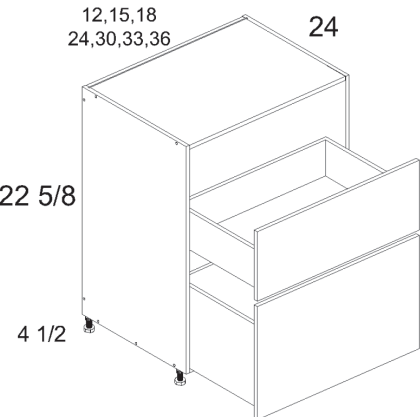

MODEL
DDR2DB12
DDR2DB15
DDR2DB18
DDR2DB24
DDR2DB30
DDR2DB33
DDR2DB36

Three Drawer Desk Bases

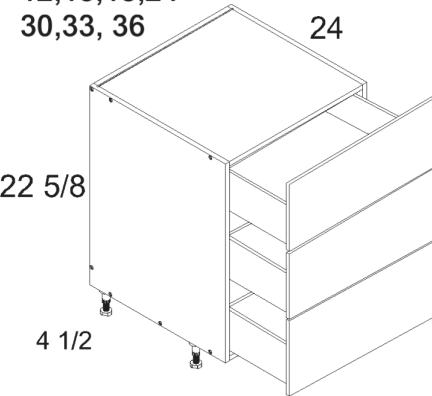

MODEL
DDR3DB12
DDR3DB15
DDR3DB18
DDR3DB24
DDR3DB30
DDR3DB33
DDR3DB36

PRODUCT SPECIFICATIONS

Two Door 13.5" Deep Stacker Wall Cabinets

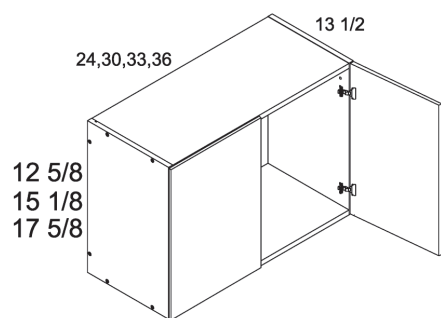

MODEL

W2412
W3012
W3312
W3612
W2415
W3015
W3315
W3615
W2418
W3018
W3318
W3618

One Door 13.5" Deep Stacker Wall Cabinets

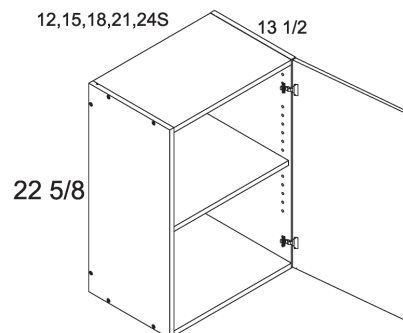

MODEL

W1223
W1523
W1823
W2123
W2423S

Two Door 13.5" Deep Stacker Wall Cabinets

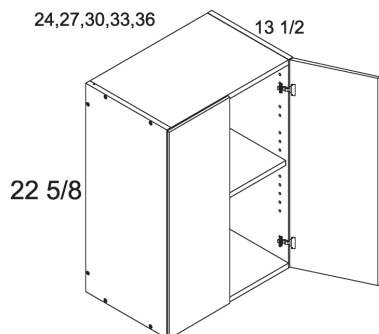

MODEL

W2423
W2723
W3023
W3323
W3623

One Door 24" Deep Stacker Wall Cabinets

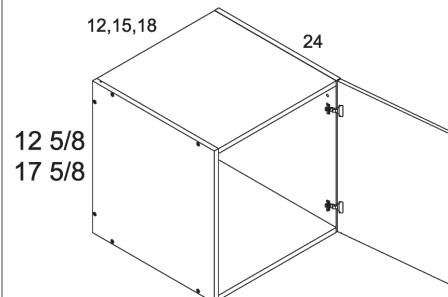

MODEL

W121224
W151224
W181224
W121824
W151824
W181824

PRODUCT SPECIFICATIONS

Two Door 24" Deep Stacker Wall Cabinets

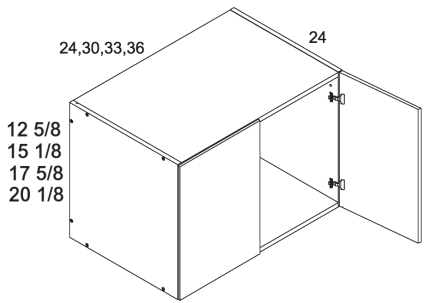

MODEL
W241224
W301224
W331224
W361224
W361524
W241824
W301824
W331824
W361824
W362024

One Door 24" Deep Stacker Wall Cabinets

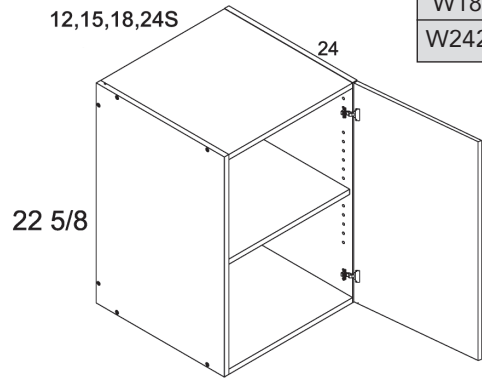

MODEL
W122324
W152324
W182324
W242324S

28

Two Door 24" Deep Stacker Wall Cabinets

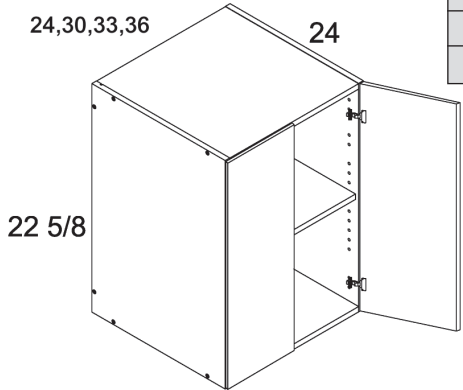

MODEL
W242324
W302324
W332324
W362324

One Door 30" High Wall Cabinets

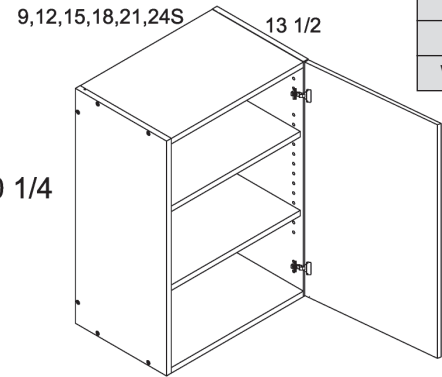

MODEL
W0930
W1230
W1530
W1830
W2130
W2430S

PRODUCT SPECIFICATIONS

Two Door 30" High Wall Cabinets

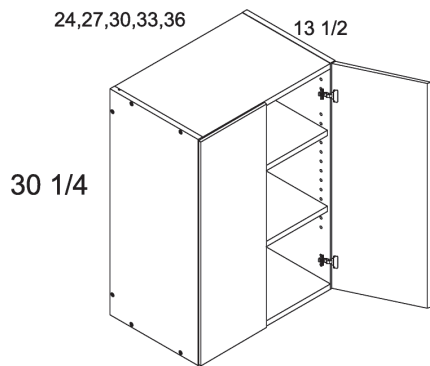

MODEL

W2430
W2730
W3030
W3330
W3630

One Door 35" High Wall Cabinets

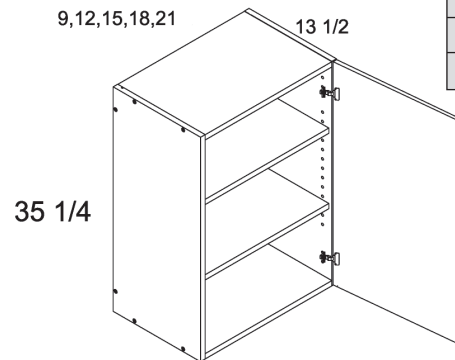

MODEL

W0935
W1235
W1535
W1835
W2135

Two Door 35" High Wall Cabinets

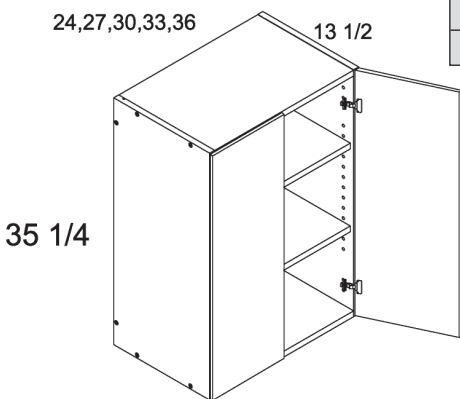

MODEL

W2435
W2735
W3035
W3335
W3635

One Door 40" High Wall Cabinets

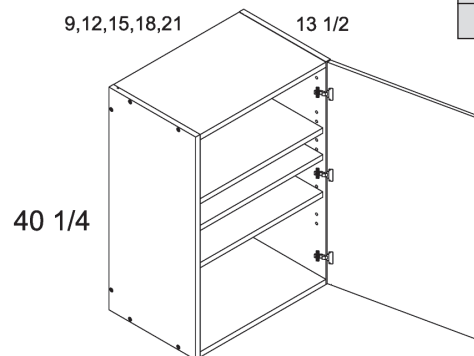

MODEL

W0940
W1240
W1540
W1840
W2140

PRODUCT SPECIFICATIONS

Two Door 40" High Wall Cabinets

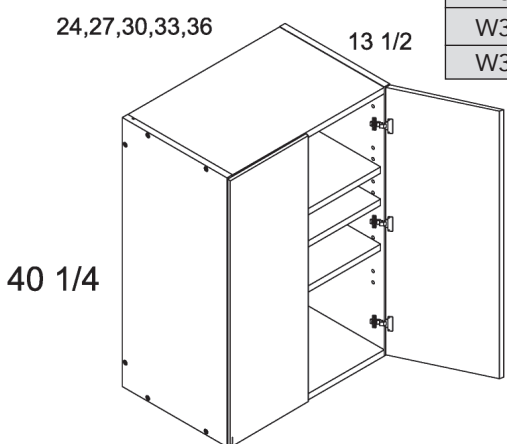

24,27,30,33,36

40 1/4

13 1/2

MODEL
W2440
W2740
W3040
W3340
W3640

13.5" Deep Flip Up Wall Cabinets

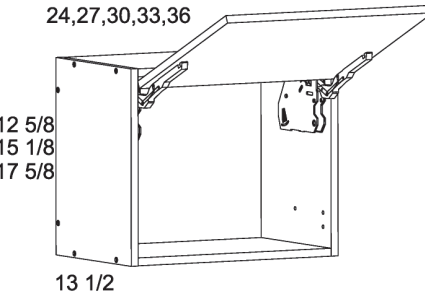

24,27,30,33,36

12 5/8
15 1/8
17 5/8

13 1/2

MODEL
WFD2412
WFD2712
WFD3012
WFD3312
WFD3612
WFD2415
WFD2715
WFD3015
WFD3315
WFD3615
WFD2418
WFD2718
WFD3018
WFD3318
WFD3618

30

24" Deep Flip Up Wall Cabinets

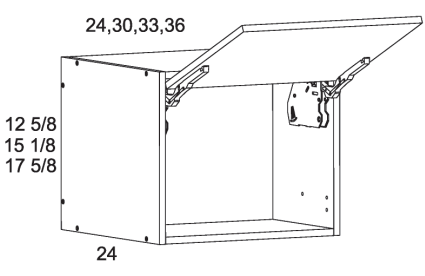

24,30,33,36

12 5/8
15 1/8
17 5/8

24

MODEL
WFD241224
WFD241824
WFD301224
WFD301824
WFD331224
WFD331824
WFD361224
WFD361524
WFD361824

Wall Blind Corner Cabinets

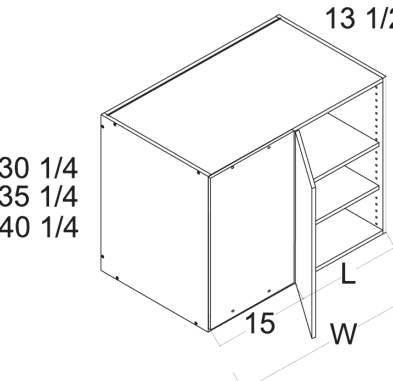

13 1/2

30 1/4
35 1/4
40 1/4

15

W

L

MODEL
WBC24/2730
WBC27/3030
WBC30/3330
WBC33/3630
WBC36/3930
WBC24/2735
WBC27/3035
WBC30/3335
WBC33/3635
WBC36/3935
WBC24/2740
WBC27/3040
WBC30/3340
WBC33/3640
WBC36/3940

CABINET	MIN.	MAX.
WBC24/27	24	27
WBC27/30	27	30
WBC30/33	30	33
WBC33/36	33	36
WBC36/39	36	39

CODE	W	L
WBC24/27	24	9
WBC27/30	27	12
WBC30/33	30	15
WBC33/36	33	18
WBC36/39	36	21

Filler required to join to adjacent cabinet (purchased separately).

PRODUCT SPECIFICATIONS

Wall Easy Reach Corner Cabinets

MODEL

WER2430

WER2435

24

24

30 1/4

35 1/4

Wall Easy Reach Corner Cabinets

MODEL

WER2440

24

40 1/4

Specialty Walls - Floating Shelves

MODEL

FS36

FS48

FS60

13

1 15/16

36,48,60

36"W Floating Shelf only has one mounting bracket.

PRODUCT SPECIFICATIONS

Tall Two Door Open Utility

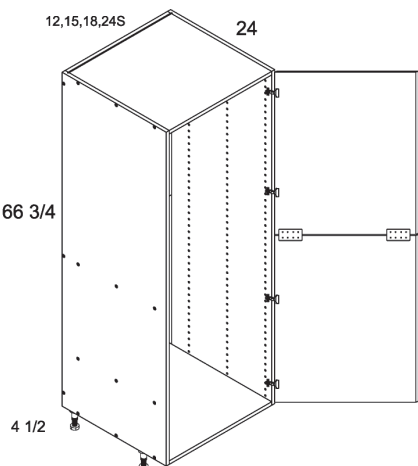

Diagram of a tall two-door open utility cabinet. The cabinet is shown from a three-quarter perspective with one door open. Dimensions are labeled: top width 12,15,18,24S; depth 24; height 66 3/4; and base width 4 1/2. A table of model numbers is provided.

MODEL
T1272
T1572
T1872
T2472S

Tall Four Door Open Utility

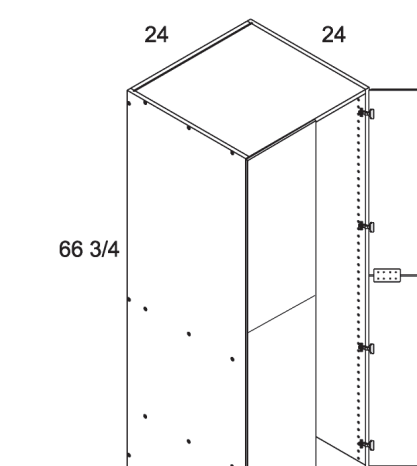

Diagram of a tall four-door open utility cabinet. The cabinet is shown from a three-quarter perspective with one door open. Dimensions are labeled: top width 24; depth 24; height 66 3/4; and base width 4 1/2. A table of model numbers is provided.

MODEL
T2472

32

Tall Two Door Utility with Shelves

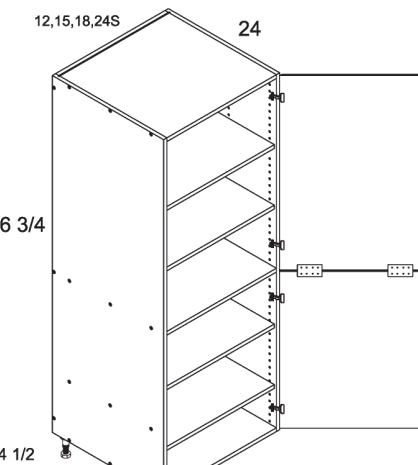

Diagram of a tall two-door utility cabinet with shelves. The cabinet is shown from a three-quarter perspective with one door open. Dimensions are labeled: top width 12,15,18,24S; depth 24; height 66 3/4; and base width 4 1/2. A table of model numbers is provided.

MODEL
TB1272FH
TB1572FH
TB1872FH
TB2472SFH

Tall Four Door Utility with Shelves

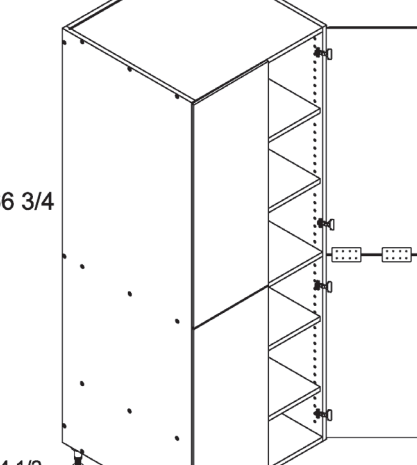
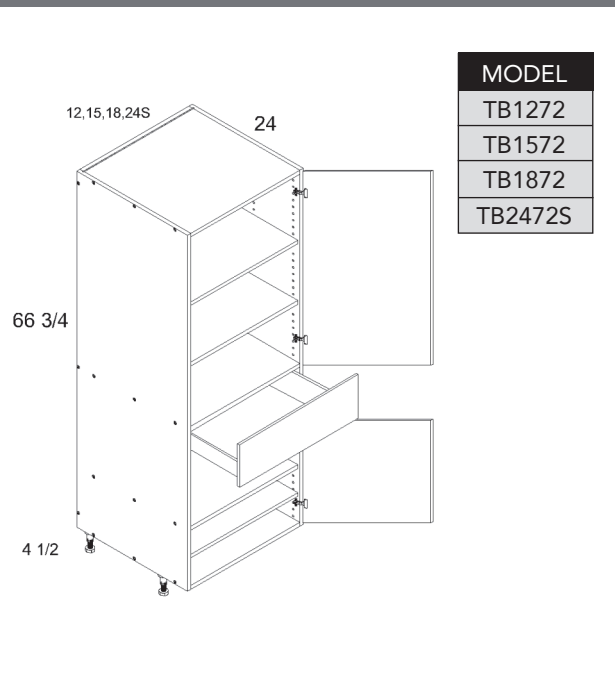

Diagram of a tall four-door utility cabinet with shelves. The cabinet is shown from a three-quarter perspective with one door open. Dimensions are labeled: top width 24,30; depth 24; height 66 3/4; and base width 4 1/2. A table of model numbers is provided.

MODEL
TB2472FH
TB3072FH

PRODUCT SPECIFICATIONS

Tall Two Door One Drawer Utility



Tall Four Door One Drawer Utility

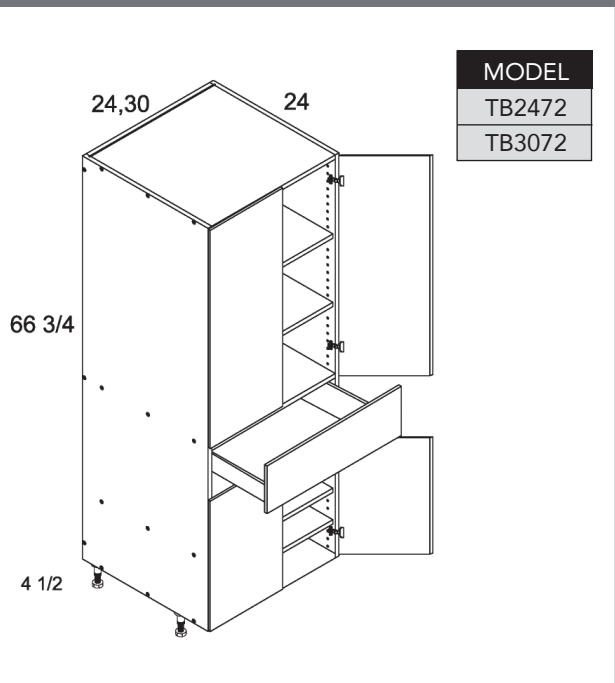

Tall One Door Two Drawer Utility

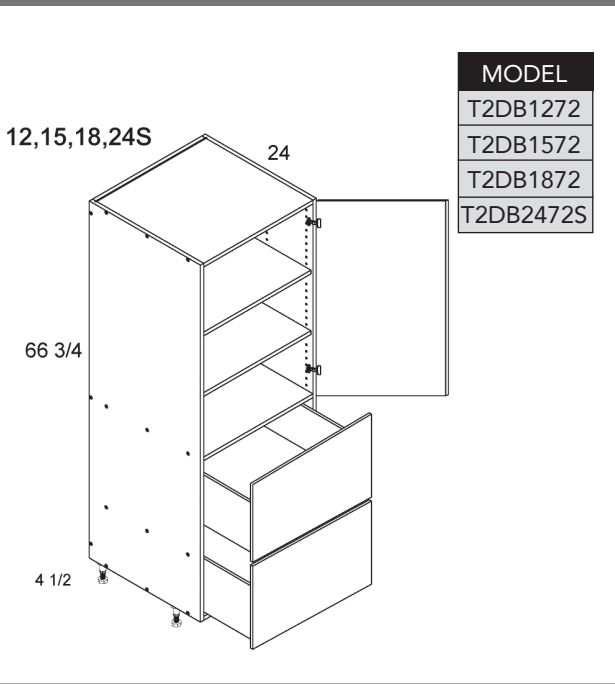

Tall Two Door Two Drawer Utility

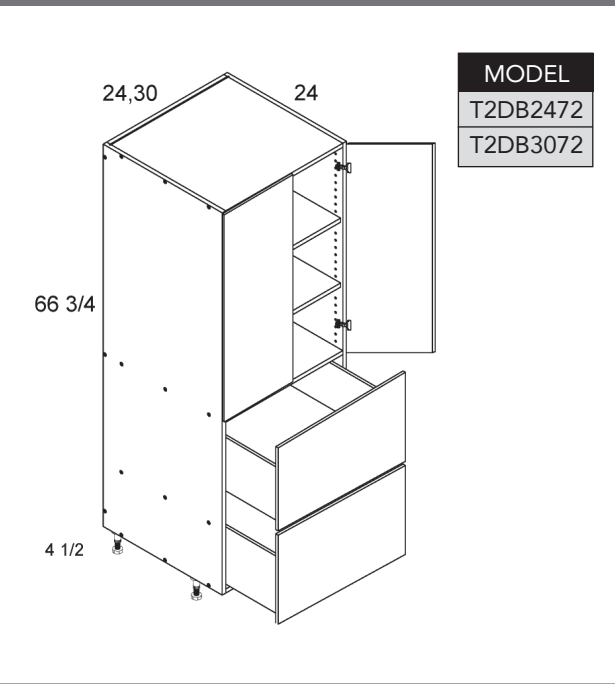

PRODUCT SPECIFICATIONS

Tall One Door Two Drawer with One Inner Drawer Utility

MODEL
T2DBID1272
T2DBID1572
T2DBID1872
T2DBID2472S

Tall Two Door Two Drawer with One Inner Drawer Utility

MODEL
T2DBID2472
T2DBID3072

Tall One Door Three Drawer Utility

MODEL
T3DB1272
T3DB1572
T3DB1872
T3DB2472S

Tall Two Door Three Drawer Utility

MODEL
T3DB2472
T3DB3072

PRODUCT SPECIFICATIONS

Tall One Door Four Drawer Utility

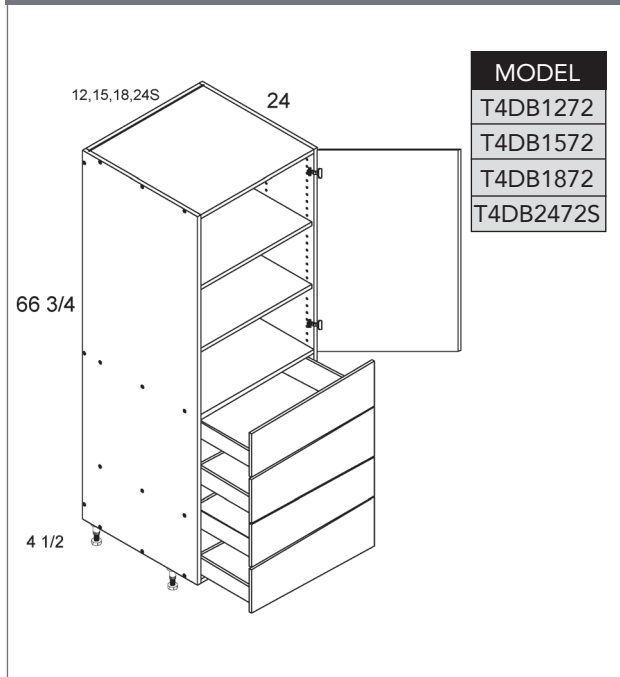

Tall Two Door Four Drawer Utility

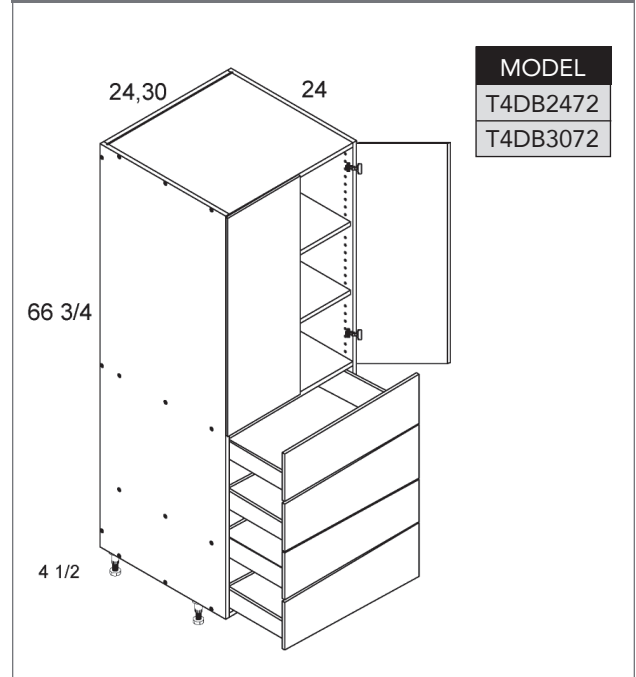

Tall Single Oven Full Height Two Door Utility

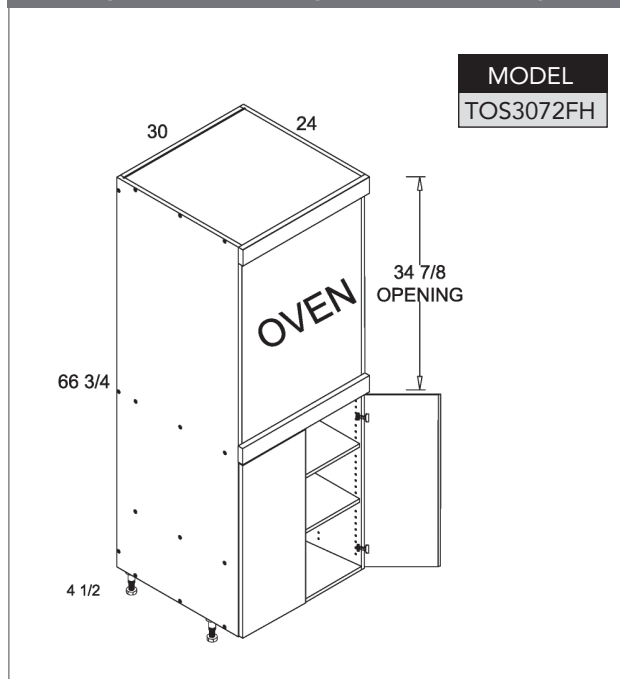

Tall Single Oven Two Door One Drawer Utility

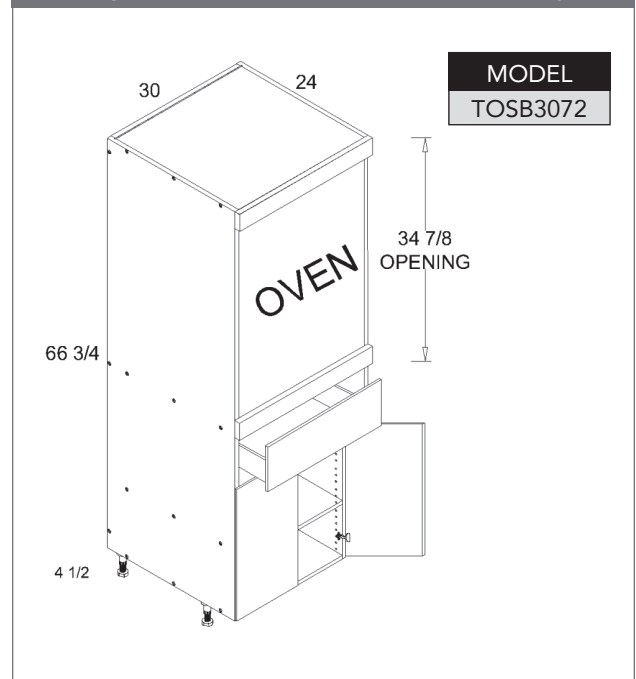

PRODUCT SPECIFICATIONS

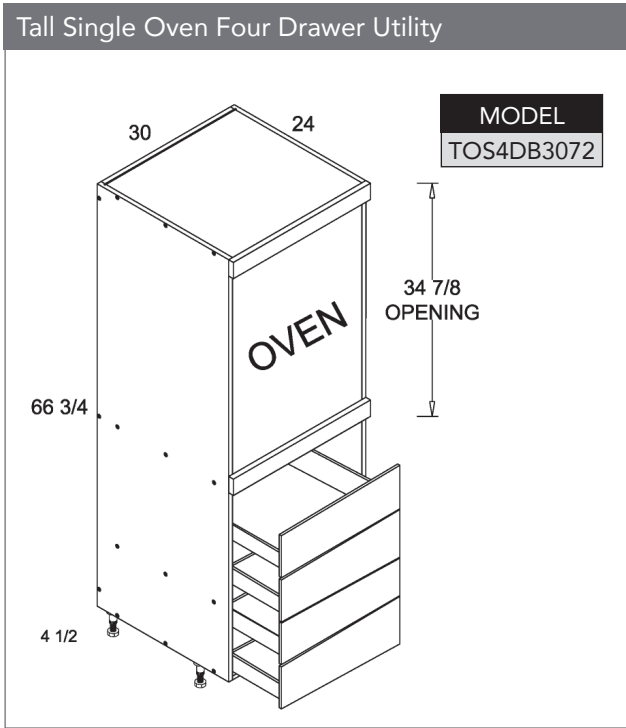
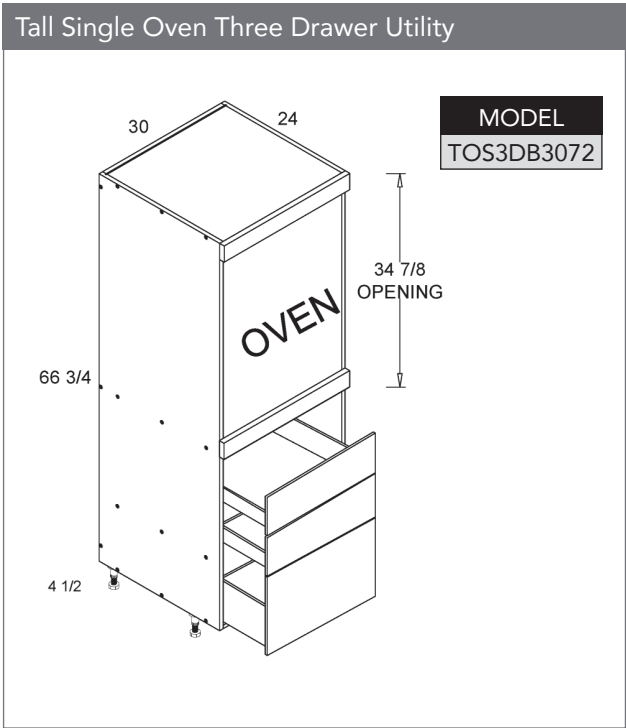
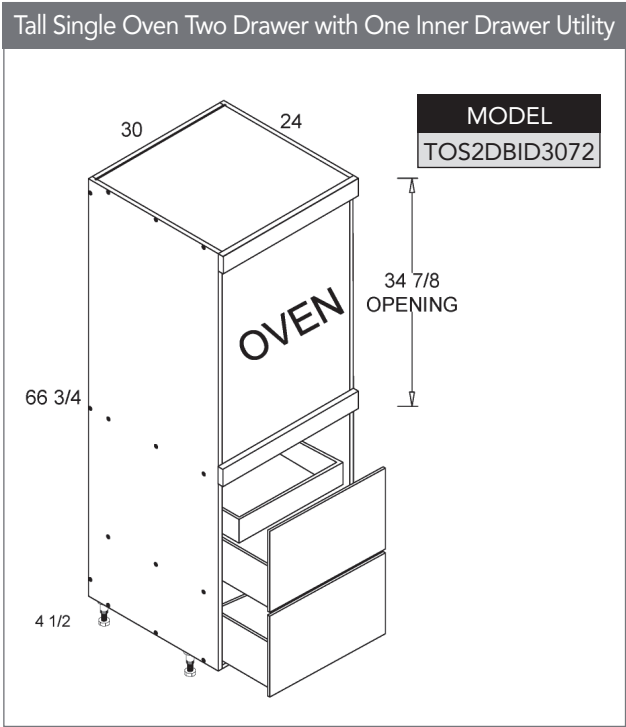
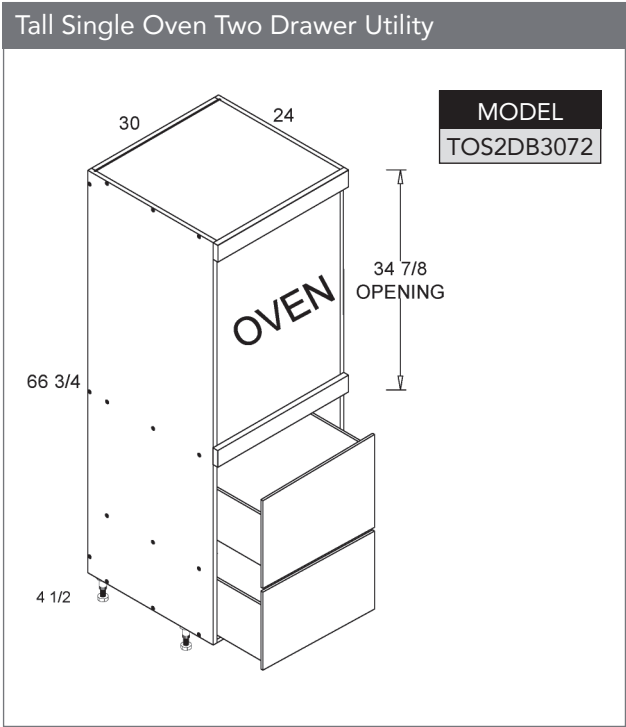

PRODUCT SPECIFICATIONS

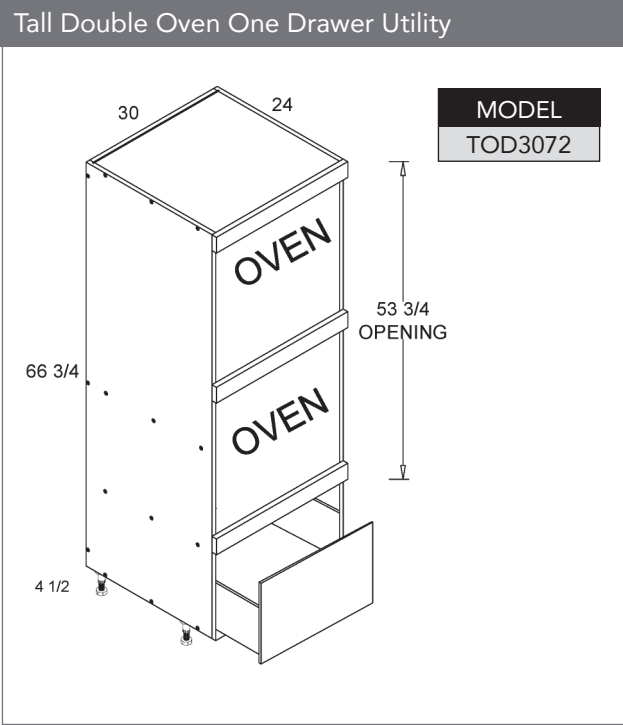

PRODUCT SPECIFICATIONS

Full Height One Door Vanity Bases

MODEL
VB12FH
VB15FH
VB18FH

One Door One Drawer Vanity Bases

MODEL
VB12
VB15
VB18

38

Two Drawer Vanity Bases

MODEL
2VDB12
2VDB15
2VDB18

Two Drawer with One Inner Drawer Vanity Bases

MODEL
2VDBID12
2VDBID15
2VDBID18

PRODUCT SPECIFICATIONS

Three Drawer Vanity Bases

12,15,18

21

30 1/4

4 1/2

MODEL

3VDB12

3VDB15

3VDB18

Four Drawer Vanity Bases

12,15,18

21

30 1/4

4 1/2

MODEL

4VDB12

4VDB15

4VDB18

Full Height One Door Vanity Sink Bases

24S

21

30 1/4

4 1/2

MODEL

VSB24SFH

Full Height Double Door Vanity Sink Bases

24,27,30,33,36

21

30 1/4

4 1/2

MODEL

VSB24FH

VSB27FH

VSB30FH

VSB33FH

VSB36FH

PRODUCT SPECIFICATIONS

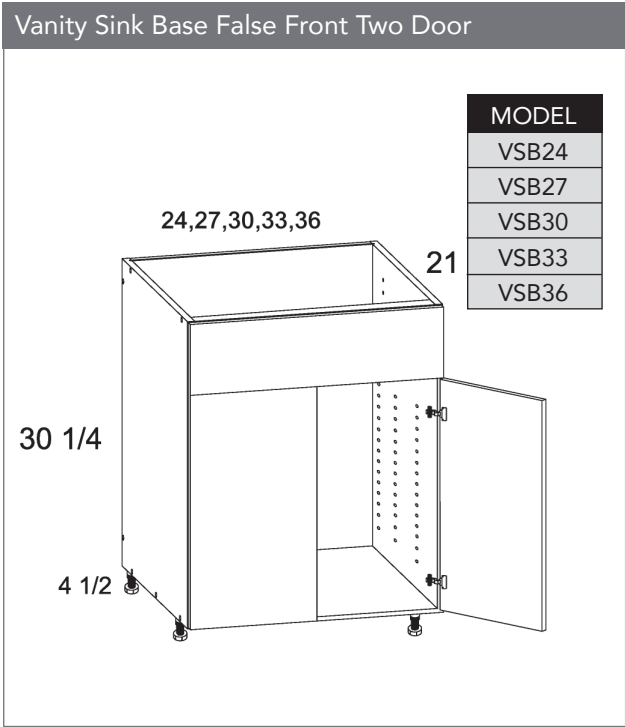
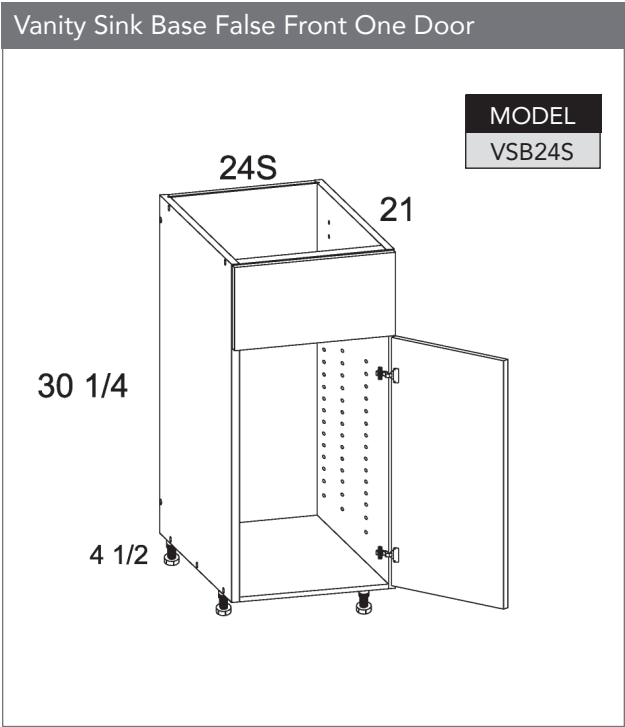

40

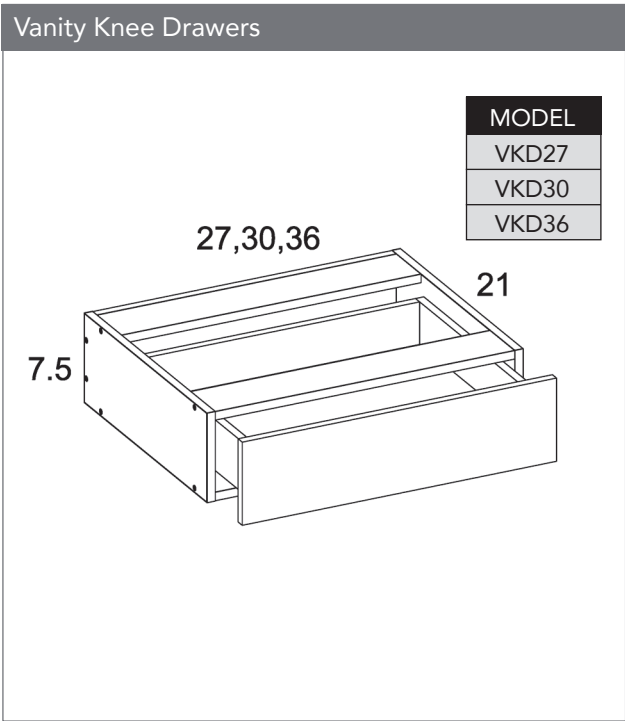

PRODUCT SPECIFICATIONS

1 3/4" Angle Crown Moulding

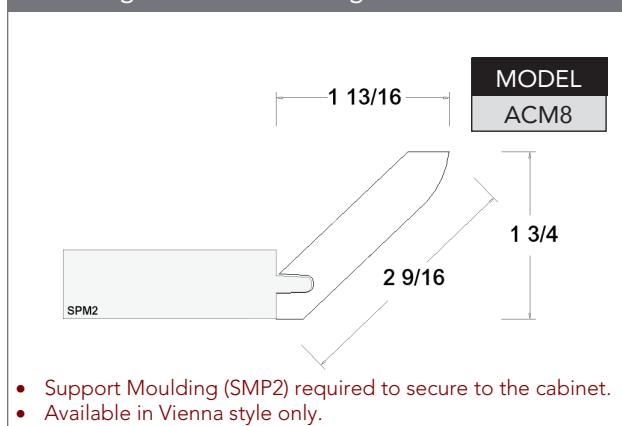

3" Angle Crown Moulding

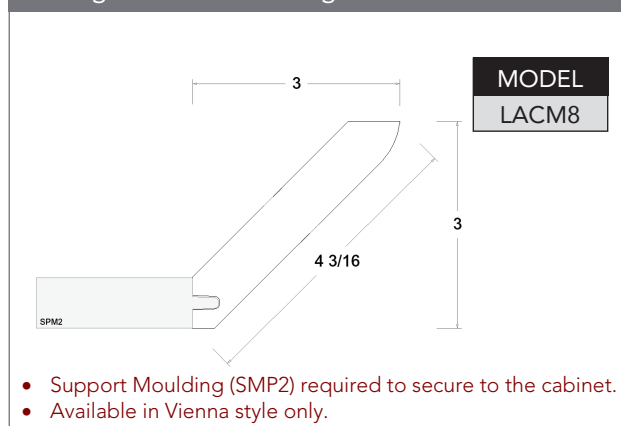

2 1/2" Cove Crown Moulding

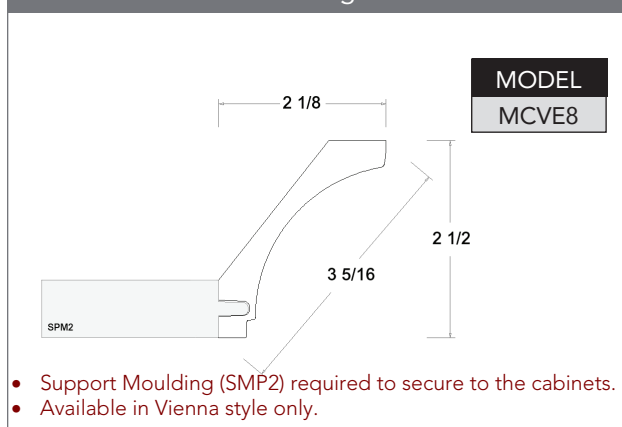

3 3/8" Cove Crown Moulding

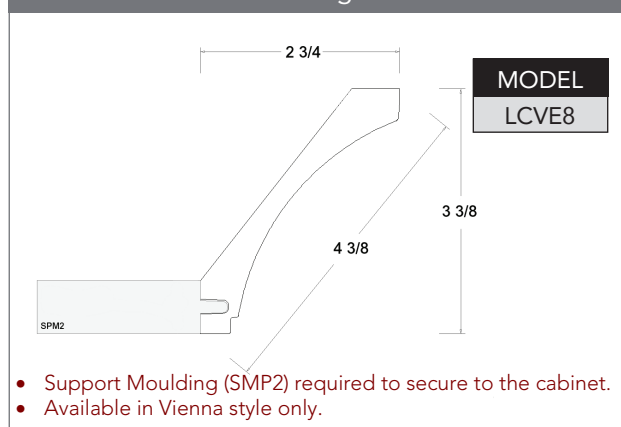

1 1/2" Light Rail Moulding

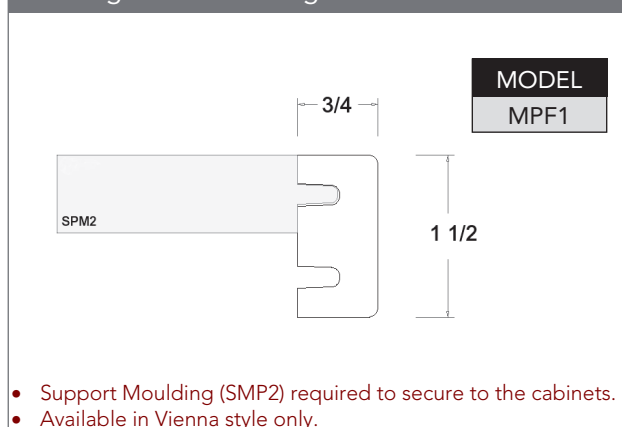

6" Crown Extension Moulding

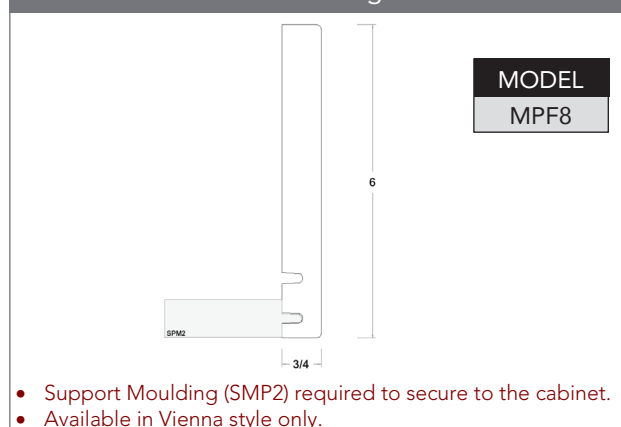

PRODUCT SPECIFICATIONS

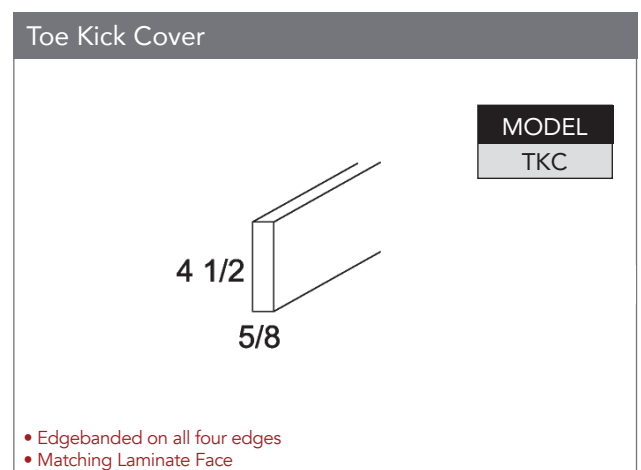
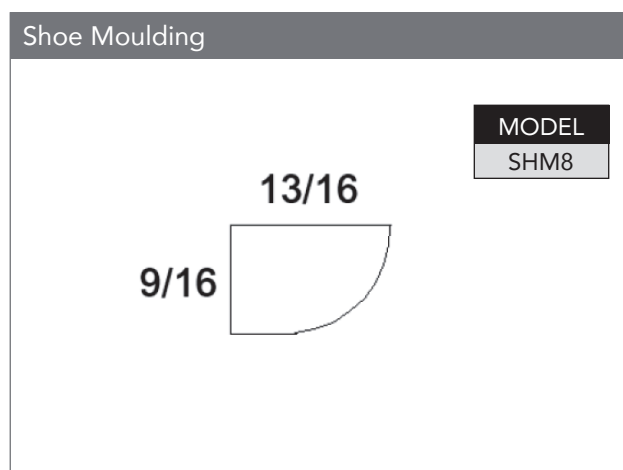
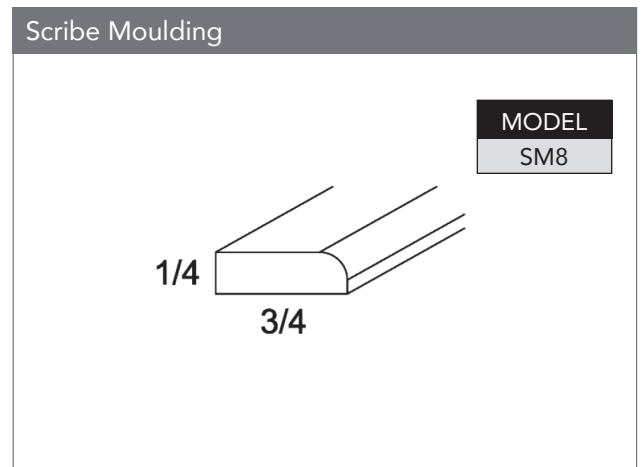
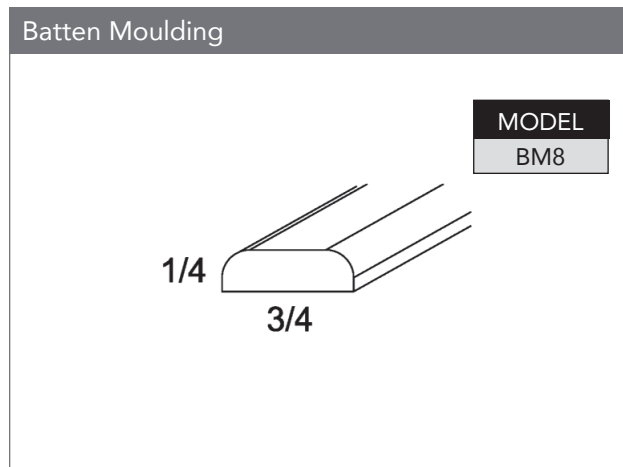
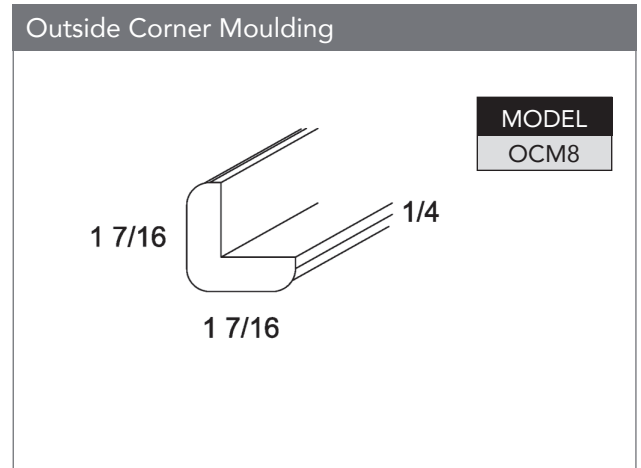
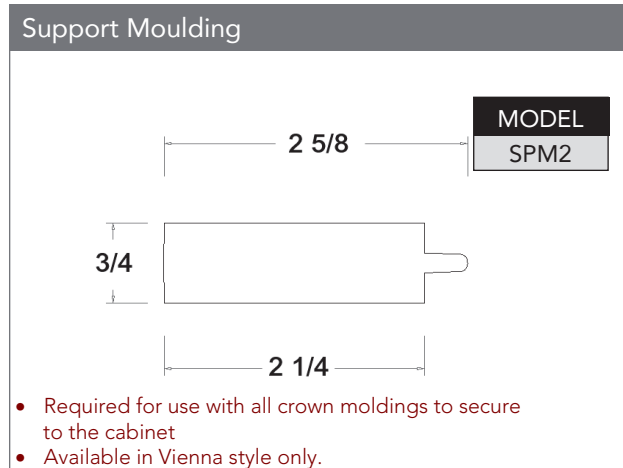

PRODUCT SPECIFICATIONS

Brushed Aluminum PVC Toe Kick Cover

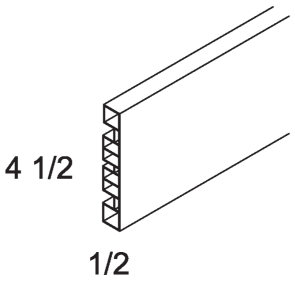

MODEL
TKC-PVC

• Brushed Aluminum Finish

PVC Toe Kick Corner Connector

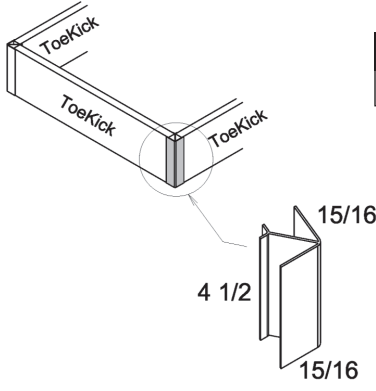

MODEL
CORNER-PVC

Furniture Base Moulding



MODEL
FBM8

• Available in Vienna style only.

PRODUCT SPECIFICATIONS

Fillers - Appliance Filler (Three Pack)

MODEL

AF3006

6

30



• Edgebanded on all four edges

Fillers - 3" Filler Overlays

MODEL

OF323

OF330

OF335

OF340

OF384

OF389

OF394

3

22 1/2

30 1/4

35 1/4

40 1/4

83

88

93

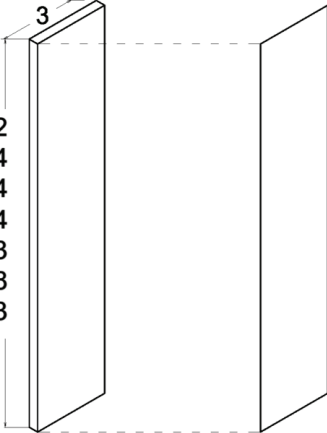

Fillers - 6" Filler Overlays

MODEL

OF630

OF635

OF640

OF684

OF689

OF694

6

30 1/4

35 1/4

40 1/4

83

88

93

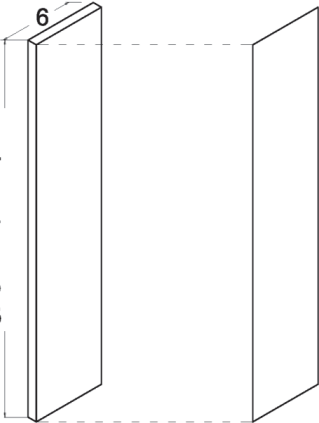

PRODUCT SPECIFICATIONS

Panels - Base End Panel

MODEL

BEP2535

25 5/16

35 1/4

3/4

• Edgebanded on all four edges

Panels - Wall End Panel

MODEL

WEP1523

WEP1530

WEP1535

WEP1540

15

22 5/8

30 1/4

35 1/4

40 1/4

3/4

• Edgebanded on all four edges

Panels - Long End Panel

MODEL

BP9642

96

42

3/4

• Edgebanded on all four edges

Panels - Tall End Panel

MODEL

TEP3096

29 7/8

96

3/4

• Edgebanded on all four edges

PRODUCT SPECIFICATIONS

