



CABINETCORP™

## SHAKER ANTIQUÉ WHITE



### SPECIFICATIONS

- Painted Cabinet with Full Overlay Doors and Drawers
- Under Mount Full Extension Soft Close Drawer Glides
- Concealed Adjustable European Style Hinges with Soft Close Feature
- Dovetail Drawer Box
- Five Piece HDF Door
- 1/2" Plywood Box with UV Coated Matching Exterior
- 3/4" Plywood Shelf with Front Edge Banding
- UV Coated Natural Interior



The team at CabinetCorp brings you 30-plus years of combined experience and knowledge supplying finished wood products to the construction and home building industry.

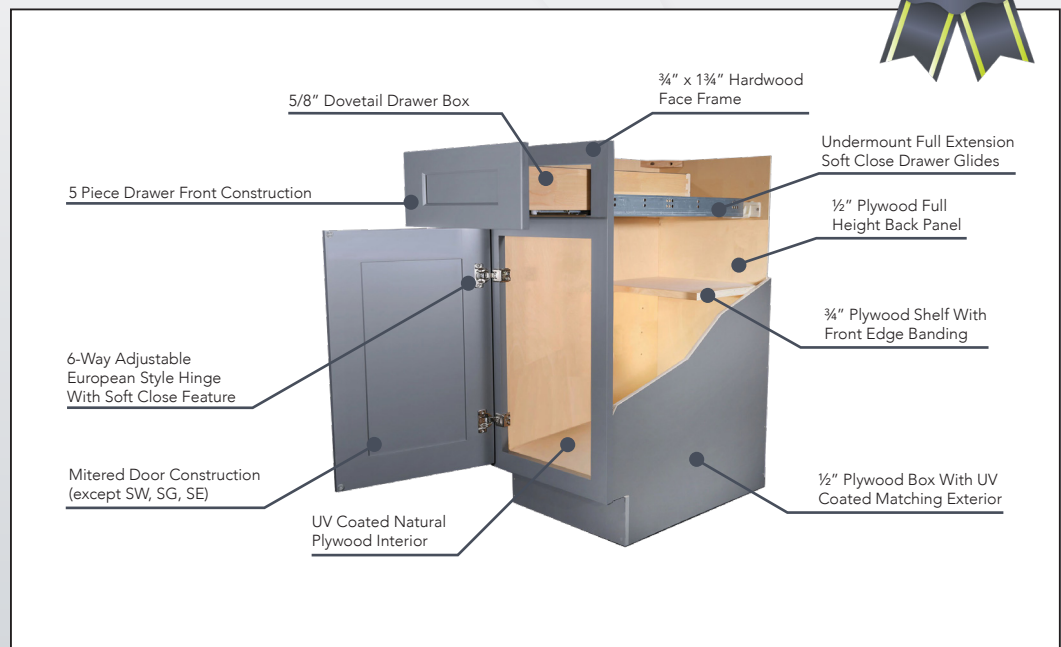

Our in-house Consultants are available for any questions you might have during regular business hours, Eastern Standard Time. Call (855) 216-7970, or just click our online "chat" button at [www.CabinetCorp.com](http://www.CabinetCorp.com).